

**Ampleforth Road, London, SE2 9BQ**

Offers Over £400,000

3 1 2



Please Quote RF0924 for all Enquires.

This beautifully extended 3-bedroom terraced house is just a short walk from Abbey Wood Crossrail and overground stations. It features a welcoming entrance hall with storage, a spacious lounge that connects to a modern kitchen, and an impressive sunroom overlooking the serene rear garden. Upstairs, you'll find three double bedrooms and a family bathroom. The private garden offers a relaxing decked area, perfect for outdoor enjoyment. A delightful family home combining convenience and charm!

## Key Features

- Please Quote RF0924 for all Enquires
- Spacious lounge
- Impressive sunroom
- Plenty of storage space
- Walking distance to Abbey Wood Crossrail and overground stations
- Three-bedroom terraced home
- Fitted kitchen
- Well-appointed family bathroom
- Private rear garden

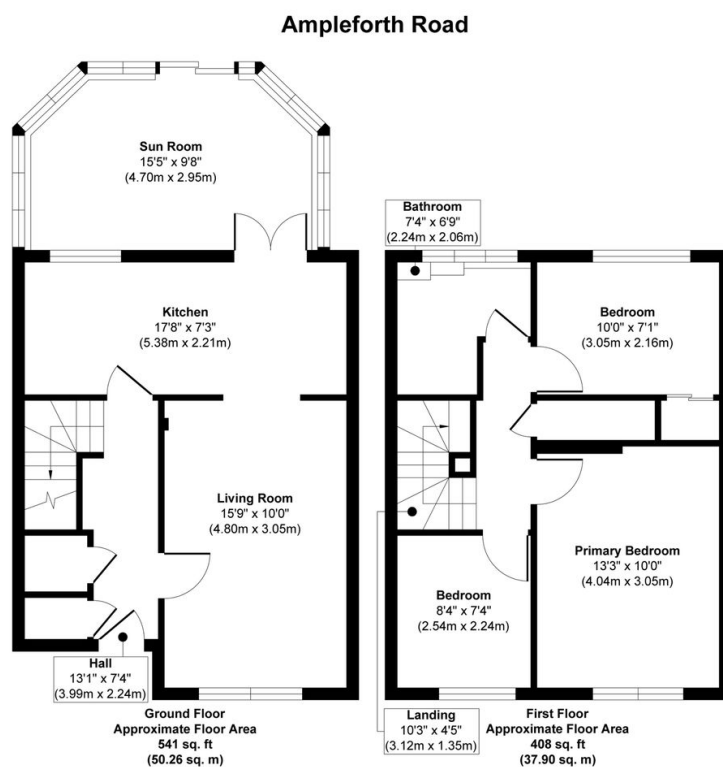

**Approx. Gross Internal Floor Area 949 sq. ft / 88.16 sq. m**

Illustration for identification purposes only, measurements are approximate, not to scale.  
Produced by Elements Property