

Homesdale Road, Bromley, BR2 9TY

2 1 1

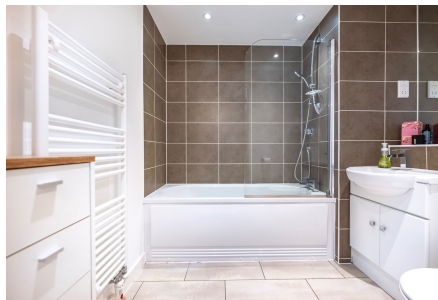

Please Quote RF0924 for all Enquires.

Immaculate two-bedroom, second-floor apartment in the heart of Bromley, featuring an open-plan living/kitchen area with integrated appliances, a large balcony, two double bedrooms (main with fitted wardrobes), and a modern family bathroom. The property includes secure gated parking and is located just 0.5 miles from Bromley South Station, offering easy access to London Victoria and nearby shops, restaurants, and leisure facilities.

Key Features

- Please Quote RF0924 for all Enquires
- Immaculate Two-Bedroom Apartment in the Heart of Bromley
- Spacious open-plan living and kitchen area with modern integrated appliances
- Large private balcony
- Stylish modern family bathroom
- Ample storage
- Secure gated allocated parking
- Close to amenities
- 0.5 miles to Bromley South Station
-

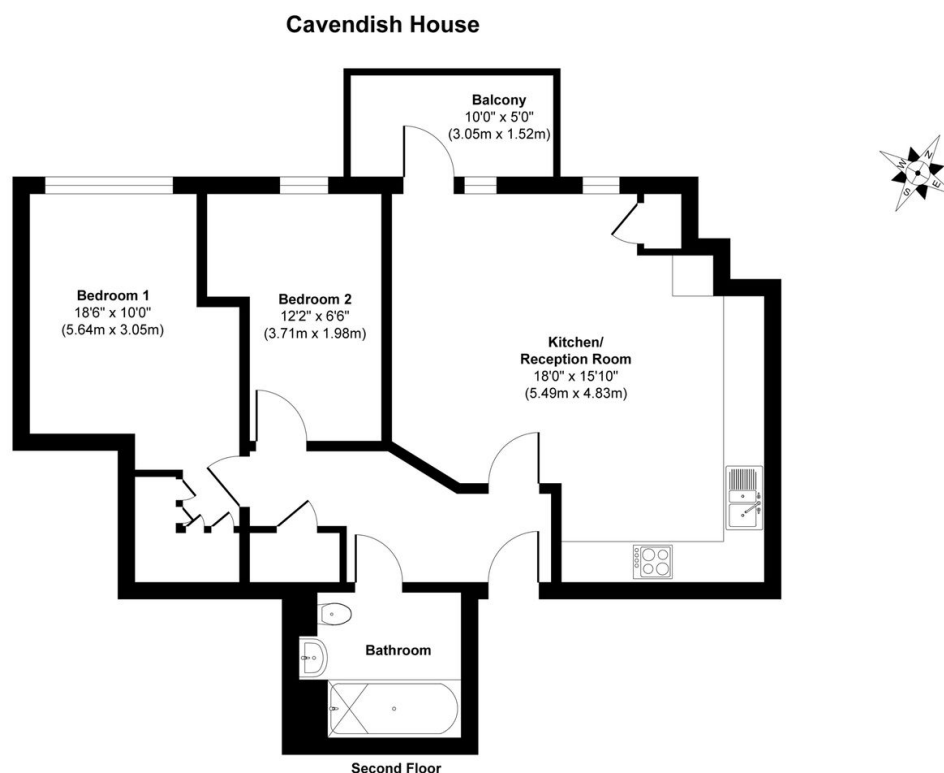

Approx. Gross Internal Floor Area 674 sq. ft / 62.60 sq. m

Illustration for identification purposes only, measurements are approximate, not to scale.
Produced by Elements Property