

Sopwith Drive, Hoo

Guide Price £300,000 - £325,000

2 1 1



CALL TO BOOK YOUR VIEWING. Guide £300,000 - £325,000. Pick up your keys and move straight in and show off your new home to friends and family. Offering a modern fitted kitchen, spacious lounge diner over looking the stylish garden, handy downstairs toilet and two double bedrooms this home is the perfect first time buy or perhaps you are looking to downsize without compromising on space? This home certainly ticks a lot of boxes. Call to register your interest **QUOTE AP0490**

Key Features

- Two double bedroom end of terrace house
- Modern interior throughout
- Side access to the garden
- Spacious lounge/diner
- Tenure Freehold/Council Tax Band B
- Allocated parking to the front
- Handy downstairs toilet
- Stylish garden ideal for entertaining
- Easy access to A2/M2
- QUOTE AP0490

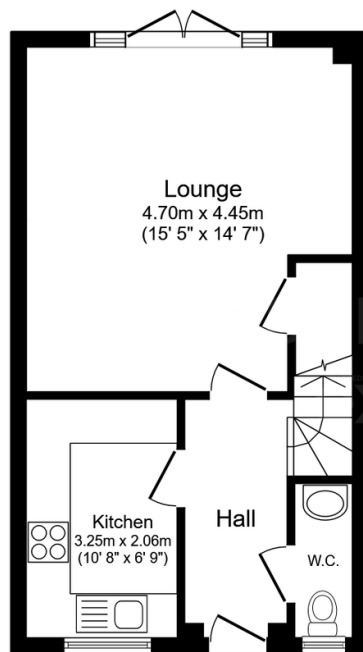

Ground Floor
Floor area 35.8 sq.m. (385 sq.ft.)

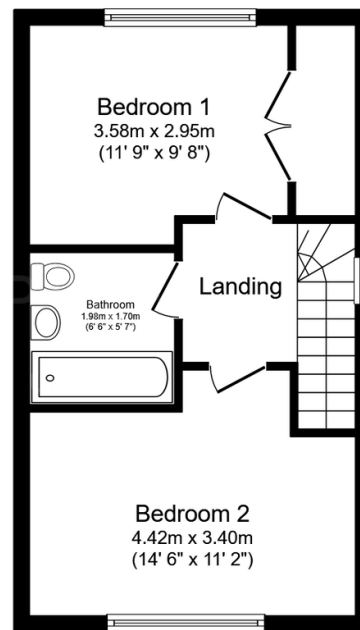

First Floor
Floor area 35.8 sq.m. (385 sq.ft.)

TOTAL: 71.6 sq.m. (770 sq.ft.)

This floor plan is for illustrative purposes only. It is not drawn to scale. Any measurements, floor areas (including any total floor area), openings and orientations are approximate. No details are guaranteed, they cannot be relied upon for any purpose and do not form any part of any agreement. No liability is taken for any error, omission or misstatement. A party must rely upon its own inspection(s). Powered by www.Propertybox.io