

## Stanton Close

Guide Price £500,000 - £550,000

4 2 1



Guide Price £500,000 to £550,000

Please Quote RF0924 for all Enquires. This charming four-bedroom detached house in Orpington offers a spacious interior with a bright reception room, modern kitchen, and potential for expansion. The first floor includes four bedrooms, two with integrated wardrobes, and a family bathroom. Externally, the property features a driveway, garage, and a south-facing garden with a patio and lawn. Conveniently located near Chelsfield Station, Orpington Rail, and the M25, the house is also close to top schools like St Olave's Grammar and Newstead Wood School.

## Key Features

- Guide Price £500,000 to £550,000
- Bright Reception Room
- Downstairs W.C.
- Driveway and Garage
- Top Local Schools
- Four-Bedroom Detached House
- Modern Kitchen
- South-Facing Rear Garden
- Excellent Transport Links
- Please Quote RF0924 for all Enquires

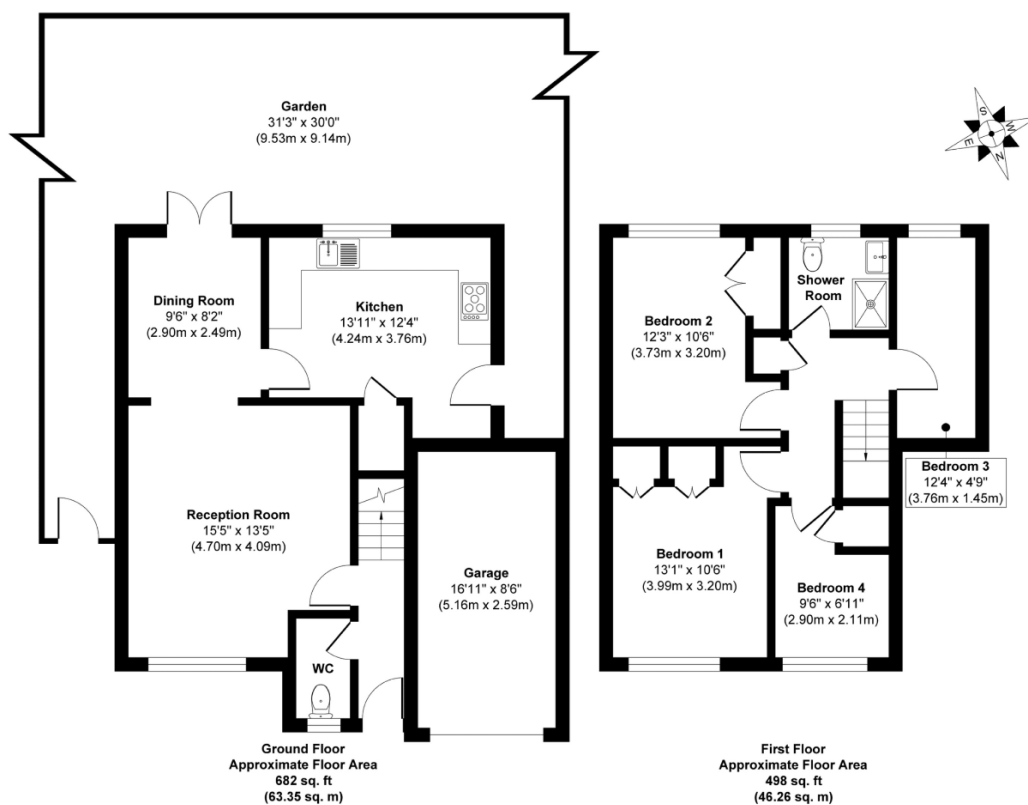

**Approx. Gross Internal Floor Area 1180 sq. ft / 109.61 sq. m**

Illustration for identification purposes only, measurements are approximate, not to scale.  
Produced by Elements Property