



LINDSAY McRAE

exp[®] UK

@ lindsay.mcrae@exp.uk.com

🌐 lindsaymcrae.exp.uk.com

☎ 07971 796 225

160 Cotterells

Guide Price £200,000

🛏️ 1 🚿 1 🚻 1



- Reference: BM 0526
- NEW BUILD development
- Gas Fired Heating to Radiator
- Modern Fitted Kitchen with Built in Appliances
- Parking Permit Available
- One Bedroom One of a Kind Duplex Flat
- UPVC Double Glazing throughout
- Modern 3 piece Shower Room
- Viessmann Combi Boiler
- No Sales Chain



Ref: BM:0526. New Quirky ONE BED DUPLEX FLAT with PRIVATE PATIO overlooking nearby Water Gardens & Town Centre! An unusual & rarely available ONE BEDROOM home just two minutes away from the TOWN CENTRE across the neighbouring park & Grand Union canal. Tucked away in this sought-after location in Hemel Hempstead. The perfect spot for busy commuters hankering after some Green space, but with a 20 minute walk to Hemel Hempstead TRAIN STATION (25 mins into London EUSTON) or 5-minute walk into the town centre. This flat benefits from a modern, 'Veissmann' combi gas boiler, UPVC double glazing, a fitted Kitchen & 3 piece Shower Room. The modern shopping street is on your doorstep & the historic High Street is a leisurely 15 minute walk away, local retail park are a short walk along the nearby canal. Available with NO SALES CHAIN.



Ground Floor

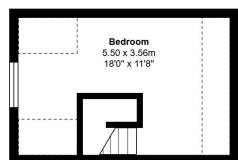

Total Area: 44.5 m² ... 479 ft²
All measurements are approximate and for display purposes only

