



CHRIS MACSWEENEY POWERED BY **exp** TM UK

@ chris.macsweeney@exp.uk.com

chrismacsweeney.exp.uk.com

☎ 07468 48 88 18

Bury Road, Shefford

£360,000

3 2 3

- NO UPPER CHAIN
- Driveway Parking for at Least 5 Vehicles
- Two Reception Rooms
- Fitted Kitchen with Adjacent Utility/Lobby
- Garage and Garden
- Tucked Away in a Popular Cul De Sac
- Three Bedrooms
- Upvc Double Glazed Conservatory
- Downstairs WC
- Quote CM0245



NO UPPER CHAIN!! A great opportunity to acquire this chalet style semi detached property that is tucked away in a popular cul de sac on the Shefford/Clifton border, close to a recreation ground and Samuel Whitbread School whist being only a short distance from Shefford town centre. The property offers significant space to include a lounge, dining room, conservatory, fitted kitchen, utility/lobby, downstairs WC, three bedrooms and bathroom. Outside offers a private, low maintenance rear garden, a 19ft (5.79m) single garage and a **DRIVEWAY FOR AT LEAST 5 VEHICLES**. Viewing is essential. Quote CM0245.



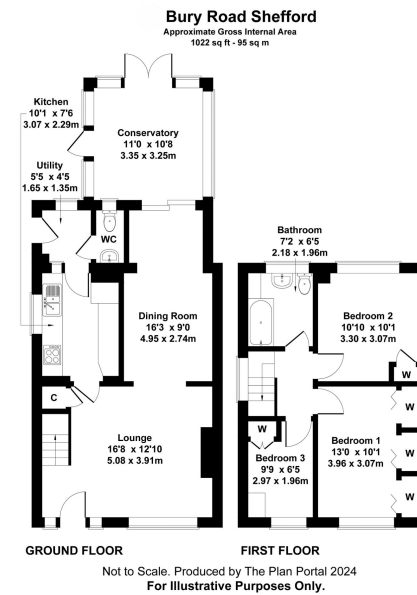

Score	Energy rating	Current	Potential
92+	A		
81-91	B		
69-80	C		78 C
55-68	D	62 D	
39-54	E		
21-38	F		
1-20	G		

eXp World UK Ltd is a registered company at Level 37, 25 Canada Square, London, E14 5LQ.

Registered company number is 12016573. VAT Registration Number is 327 4120 29