

Pine Grove, Hempstead, Gillingham, ME7 3QP

£300,000

2 1 1

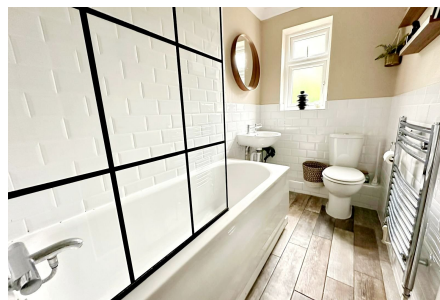

Ready to move into from day one! This home in the ever sought after Hempstead location would make an ideal first home. Boasting a contemporary kitchen and bathroom whilst not forgetting the recently completed media wall in the lounge. There's plenty on offer from double bedrooms, a garage, allocated parking and outside space to enjoy the sunshine. A stone's throw from Hempstead valley shopping centre this home is likely to attract plenty of interest so call to arrange your viewing.

Key Features

- 2 Bedroom End of Terrace Home
- Modern Kitchen And Bathroom
- An ideal First Time Buy
- Access to M2 Motorway
- Tenure Freehold / Council Tax C
- Stunning Lounge With Feature Wall
- Sought after Hempstead Location
- Short Distance To Hempstead Valley Shopping Centre
- Garage En Bloc & Allocated Parking
- QUOTE AP0490

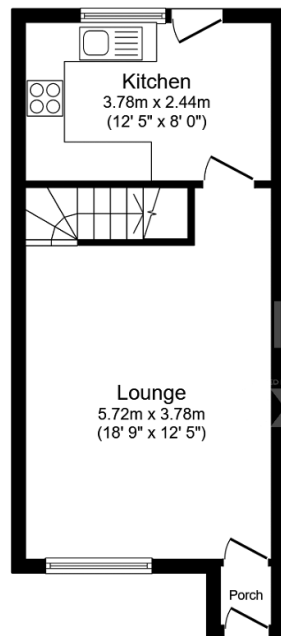

Ground Floor
Floor area 32.0 sq.m. (345 sq.ft.)

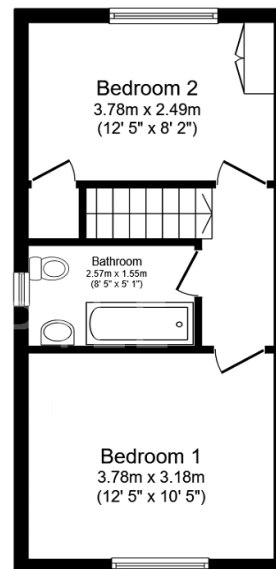

First Floor
Floor area 31.2 sq.m. (336 sq.ft.)

TOTAL: 63.3 sq.m. (681 sq.ft.)

This floor plan is for illustrative purposes only. It is not drawn to scale. Any measurements, floor areas (including any total floor area), openings and orientations are approximate. No details are guaranteed, they cannot be relied upon for any purpose and do not form any part of any agreement. No liability is taken for any error, omission or misstatement. A party must rely upon its own inspection(s). Powered by www.Propertybox.io