

Devonshire Square, Bromley, BR2 9HX

Guide Price £475,000

2 1 1



- Guide Price £475,000 - £500,000
- Beautifully refurbished two-bedroom house
- Spacious lounge/dining room
- Low maintenance garden
- Generously sized bathroom
- EPC Rating: C
- Within the catchment of highly regarded schools
- Close to shops and amenities
- Short walk to Bromley South station
- Please Quote RF0924 for all enquiries

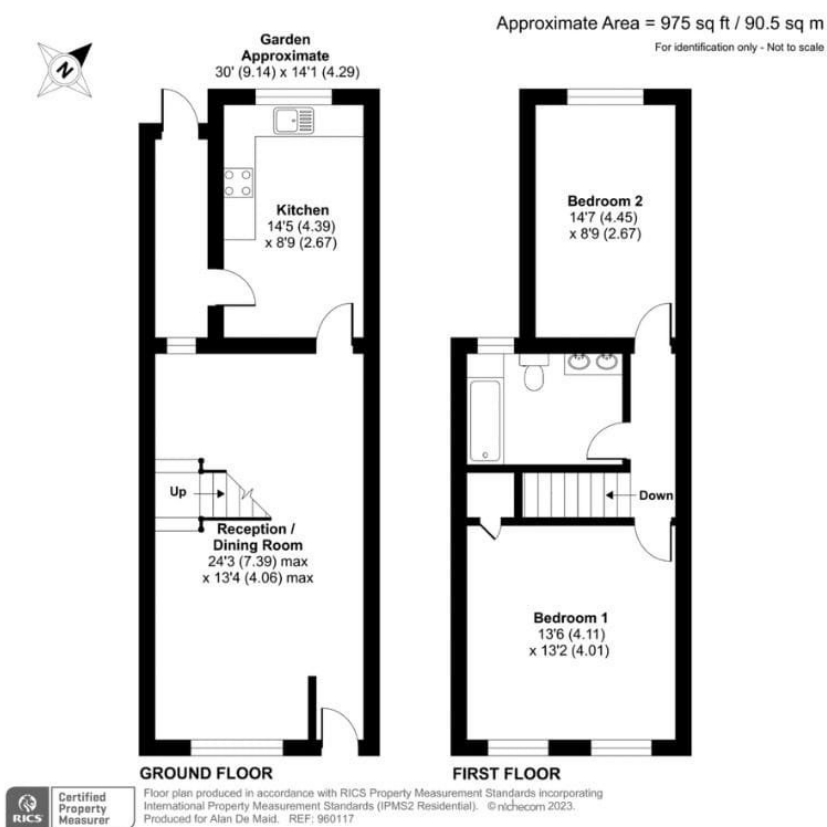

GUIDE PRICE £475,000 - £500,000 - A beautifully presented and tastefully decorated two-bedroom mid-terraced house that has been subject to considerable and comprehensive refurbishment over recent years. The property is situated in a sought-after location within walking distance from Bromley High Street and Bromley South Mainline Station affording a fast and regular service to London Victoria. Please Quote RF0924 for all enquiries