



Whitelands Avenue, Chorleywood

Guide Price £900,000

 4  2  0



A detached four bedroom family home situated on the ever popular Whitelands Avenue

*** PLEASE QUOTE REF KW0404***

Key Features

- Detached
- Two bathrooms
- Walking distance to the Metropolitan Line Station
- Close to Chorleywood Village
- Ideally Located
- Four good sized bedrooms
- Driveway parking
- Landscaped garden
- Garage
- Close to excellent schools

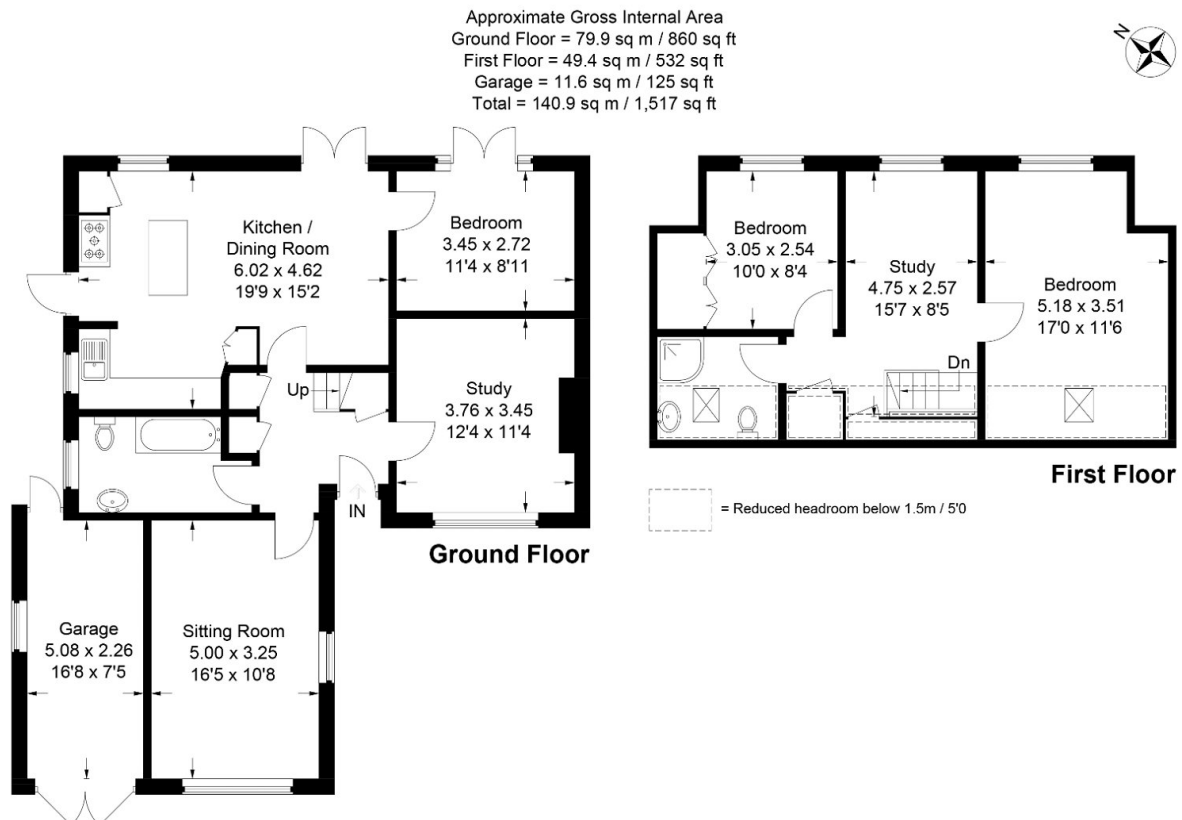

This plan is for layout guidance only. Not drawn to scale unless stated. Windows and door openings are approximate. Whilst every care is taken in the preparation of this plan, please check all dimensions, shapes and compass bearings before making any decisions reliant upon them.
 © CJ Property Marketing Ltd Produced for Kate Woodward EXP