

# Homefield Rise, Orpington, BR6 0RT

£300,000

1 1 1



- Luxury Apartment.
- High Standard Kitchen fittings.
- Secured Parking that can accommodate EV Lifestyle.
- Winter Garden.
- Situated in Prime location Orpington High Street.
- Open Plan Living.
- Fitted wardrobes and hallway cupboards.
- Berkeleys Development.
- NHBC warranty.
- Please Quote RF0924 for all Enquires.

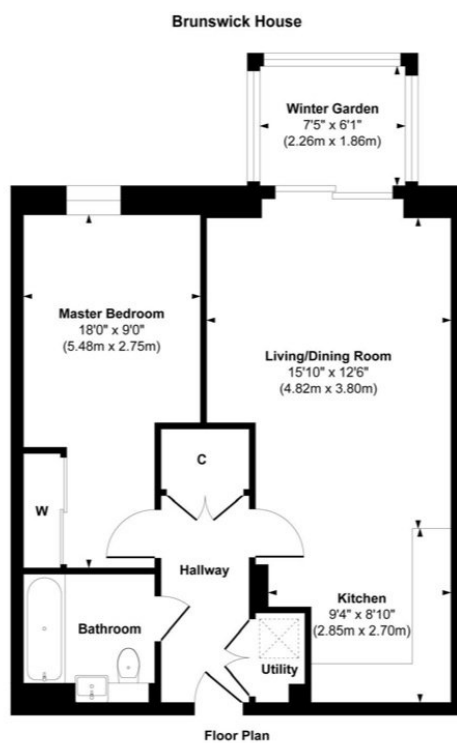

Approx. Gross Internal Floor Area 540 sq. ft / 50.30 sq. m  
Illustration for identification purposes only, measurements are approximate, not to scale.  
Produced by Elements Property

Please Quote RF0924 for all Enquires.

Welcome to Brunswick Squire. I'm thrilled to present a modern one-bedroom apartment situated in Brunswick House, right in the vibrant heart of Orpington. Enjoy easy access to retail stores, restaurants, and exceptional schools. Plus, it's just a short 15-minute walk to Orpington station, offering direct trains to London Bridge in a quick 18 minutes.