



TWYN GABLES

Newlands Lane | Meopham | Kent | DA13 0RD

STUART REYNOLDS

POWERED BY
exp™ UK



Summary

Originally built as a Bungalow in the 1960's, Twyn Gables has undergone many major improvements over the years and as a local agent, I have been exceptionally privileged to have witnessed it's transformation with each visit, spanning the last 23years.

Having been extended in the loft space in the early 2000's, the home was further improved by it's current owners to create even more space. Coming in at just over 1,600SqFt and with Bedrooms on both the Ground & First Floors, the versatility of this Detached home is immeasurable. Approached via private, gated entrance, the large driveway gives space to multiple vehicles and leads to the car port. Once inside, you can't help but be super impressed by the expanse of living space on show. The 25ft Conservatory can be accessed from either the modern Kitchen/Breakfast Room or the 22ft Lounge and enjoys a glorious view across the large, private Garden. Of the 5 Bedrooms available, three are located upstairs along with an En-suite Bathroom and Family Shower Room making 3 washrooms overall.

The available space isn't just confined to inside the property as the Garden Cabin is an excellent addition which could provide a multitude of uses plus there is an adjoining Sauna Room with separate toilet and shower cubicle. Located along a quiet, country lane to the South of Meopham, the setting for this home will most certainly favour the buyers who are wanting an escape from larger, more built up urban environments in favour of a Village lifestyle and because there are so many amenities within easy reach, this home really does offer the best of both Town & Country living. The nearest Bus Stop is literally at the end of the road and access links to the M20 & M2 are reachable in under 3miles. For those with a commute to consider, no fewer than three Rail Stations are accessible inside 4miles and the selection of Shops and Schools nearby are fantastic.



Ground Floor

Entrance Hallway

Lounge - 22'8 x 11'10

Kitchen/Breakfast Room - 14'9 x 9'7

Conservatory - 25'10 x 11'2

Utility Room - 11'8 x 4'8

Bedroom - 17 x 11'10

Bedroom - 14'9 x 8

Shower Room

First Floor

Landing

Master Bedroom - 13'3 x 11'9

Walk In Wardrobe

Ensuite Bathroom

Bedroom - 17'1 x 8'7

Ensuite Shower Room

Bedroom - 11'4 x 8'6

Outside

Gated Driveway

Car Port

Spacious Private Garden

Garden Cabin - 17'9 x 16'9

Sauna & Shower Area

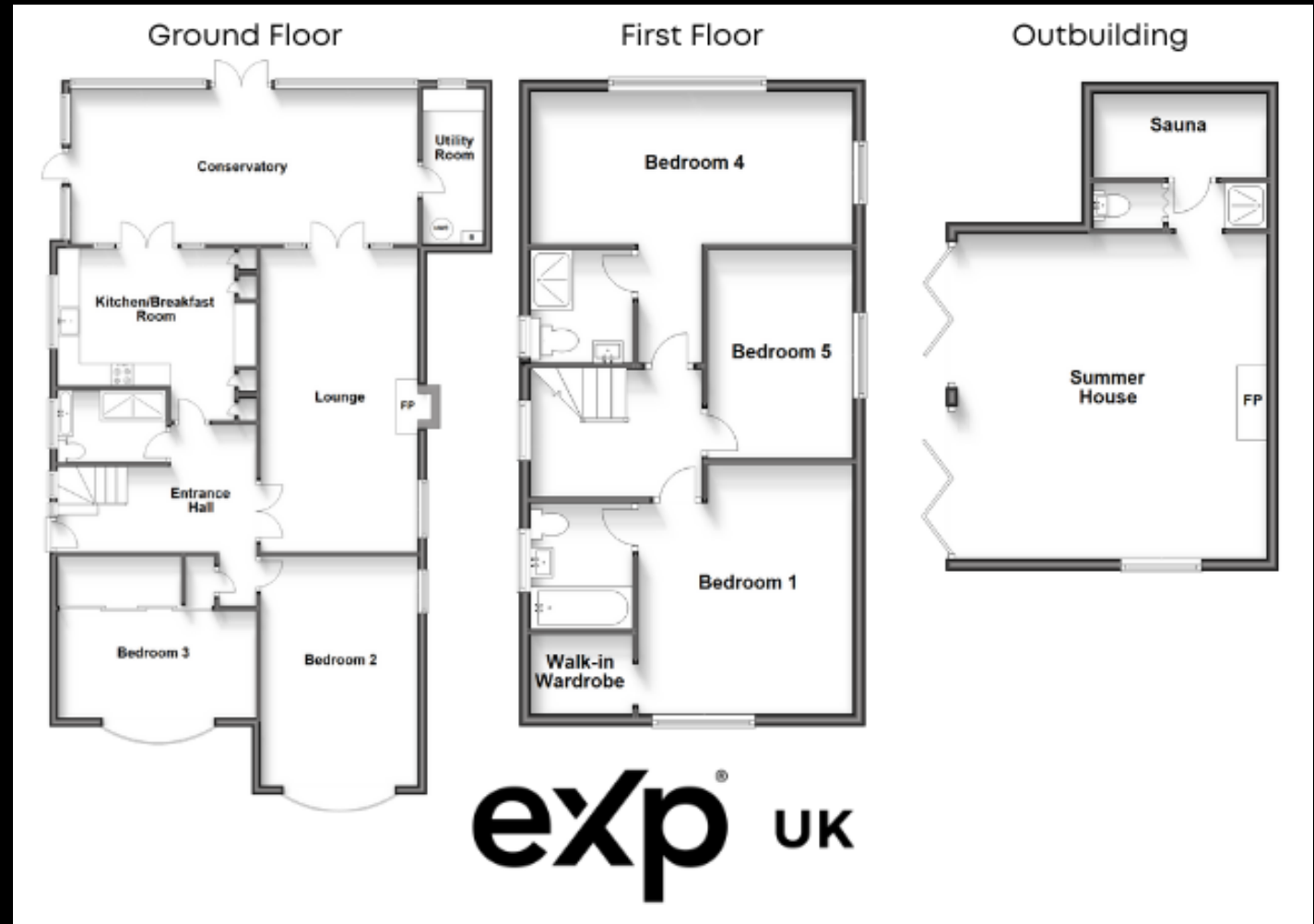



STUART REYNOLDS
exp
01732 647009
FOR SALE
f y i t @sreynoldsrealestate



01732 647009

f y i t @sreynoldsrealestate