



Strand Street, Sandwich, CT13 9DZ

£645,000

3 2

A wonderful medieval townhouse, originally owned by a wealthy merchant, with generous and versatile accommodation spread over three floors and situated in the heart of the historic Cinque Port of Sandwich. The home dates back to circa 1470 and retains some lovely period features, including a wealth of exposed beams and some lovely fireplaces.

- A wonderful medieval townhouse
- Dates back to circa 1470 and retains some lovely period features
- Versatile accommodation spread over three floors
- Sympathetically refurbished to create a blend of modern and heritage style
- Heritage style kitchen and living/dining room
- First floor: Large lounge, Bedroom and bathroom



Floor Area: 1850 sq. ft.

Tenure: Freehold

Service Charge: £0 per annum

Ground Rent: £0 per annum

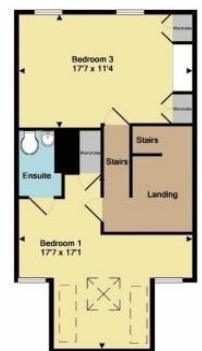
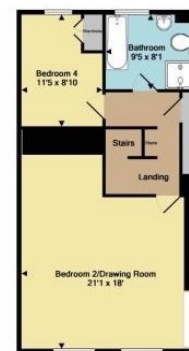
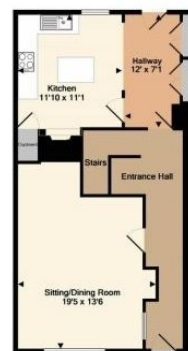

Total Approx. Floor Area 1850 Sq Ft. (171.9 Sq M.)
Measurements are approximate. Refer to scale. Illustrations proposed only.
Made with ARCHICAD 2021.