



LEE QUIGLEY POWERED BY **exp** TM UK

@ lee.quigley@exp.uk.com

leequigley.exp.uk.com

07787 445 950

Rugby Road, Worthing, BN11

£700,000

🛏️ 4 🚿 2 🛋️ 3



- Four Double Bedrooms
- Landscaped Rear Garden
- Purpose Built Pizza Oven in Garden
- Feature 43.5 ft Lounge Diner & Conservatory Total Open Space
- Fantastic Location
- En-suite to Master Bedroom
- Grand Avenue District
- Very Well-Presented
- EPC - D
- Council Tax - D



We are delighted to bring to market this FOUR DOUBLE BEDROOM family home situated in the Grand Avenue District of West Worthing. Within a short walk of local transport links, Goring High Street Parade of Shops with local restaurants, micro bars & convenience stores, also The Seafront is a 15 minute stroll away.

Benefits include off road parking for 2/3 cars, a feature Lounge/diner/conservatory of roughly 43.5ft, a landscaped rear garden with purpose built Pizza Oven.

Further features are a utility room, side lean too for a handy storage area, en suite to master bedroom and being very well presented throughout.

Viewings recommended.

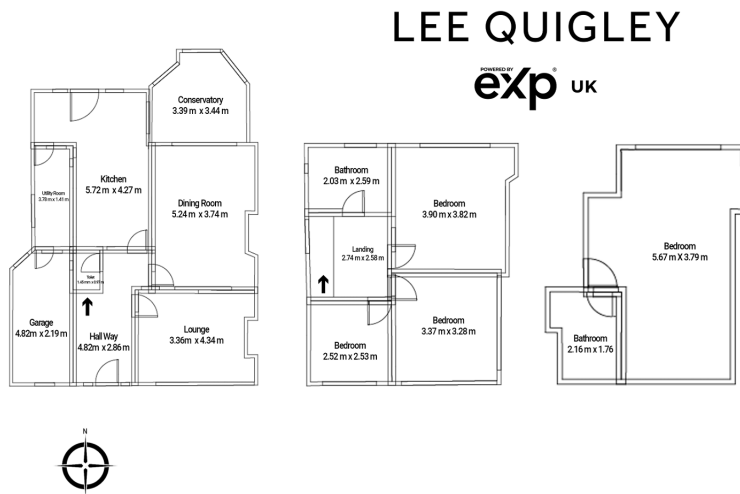

Score	Energy rating	Current	Potential
92+	A		
81-91	B		
69-80	C		73 C
55-68	D	56 D	
39-54	E		
21-38	F		
1-20	G		