



POWERED BY
PAUL COUTTS **exp**™ **UK**

@ paul.coutts@exp.uk.com

🌐 paulcoutts.exp.uk.com

☎ 07877 926 722

SLEEPY HOLLOW, ARDELVE, KYLE OF LOCH ALSH, IV40 8DY OFFERS OVER £265,000

- PICTURESQUE LOCATION
- STUNNING VIEWS ACROSS LOCH ALSH
- MINUTES FROM DORNIE & EILEAN DONAN CASTLE
- UNIQUE PROPERTY FULL OF CHARACTER
- WELL PRESENTED ACCOMMODATION
- SELF CONTAINED ANNEXE
- IDEAL FOR HOLIDAY LET
- VIEWING HIGHLY RECOMMENDED

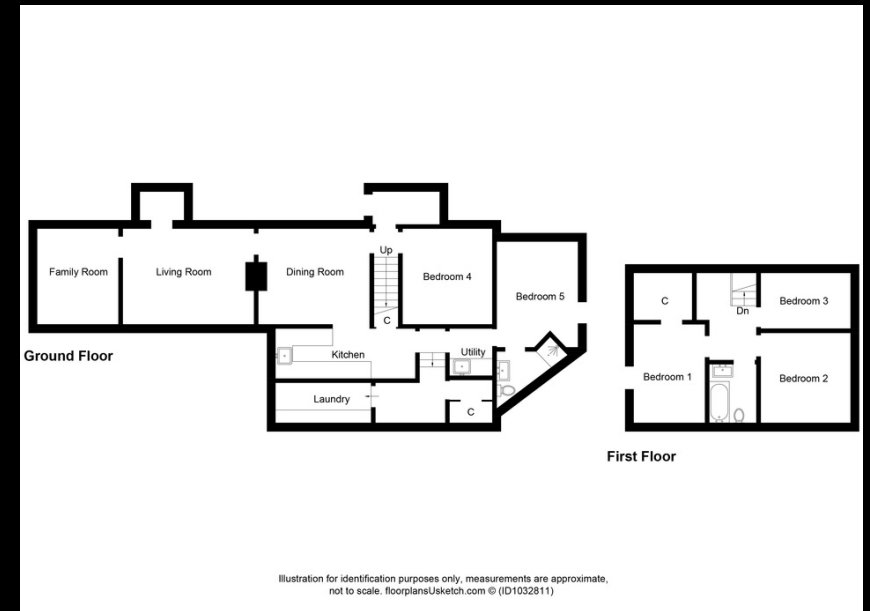



eXp World UK Ltd is a registered company at Level 37, 25 Canada Square, London, E14 5LQ.
Registered company number is 12016573. VAT Registration Number is 327 4120 29

PAUL COUTTS

POWERED BY
exp UK

FOR SALE

01463 224802/ 07877926722

paul.coutts@exp.uk.com



Comprehensive, modern marketing



Round the clock service



Simple and easy to understand fee



Genuine local knowledge and vast
experience