



CAREN GILBERT-WEEDMAN

**exp**<sup>®</sup> UK

@ [caren.gilbertweedman@exp.uk.com](mailto:caren.gilbertweedman@exp.uk.com)

 [carengilbertweedman.exp.uk.com](https://carengilbertweedman.exp.uk.com)

 07970 080 010



## 22 Concorde House, 6 Canal Street, Chester CH1 4FF

Offers In Region Of £155,000

1 1 1



- ONE BEDROOM FIRST FLOOR • MODERN and STYLISH APARTMENT
- IDEAL FOR FIRST TIME BUYER
- MUST BE VIEWED TO BE APPRECIATED
- LEASEHOLD 993 YEARS REMAINING
- QUOTE FOR VIEWING - REF - CG0525
- KITCHEN AND SHOWER ROOM
- ELECTRONIC BLINDS ON THE WINDOWS
- CENTRAL TO CHESTER CITY CENTRE
- NO ONWARD CHAIN / EPC - C / COUNCIL TAX B
- SERVICE CHARGE £723.60 per annum





QUOTE FOR VIEWING - REF - CG0525

This immaculate first-floor flat offers a no chain sale with fantastic opportunity for couples or first-time buyers seeking a stylish home in the heart of Chester with a modern design and prime location just outside of the city walls.

The flat features an open-plan layout for the kitchen, dining, and lounge area, creating a spacious, cohesive space ideal for modern living. The bespoke kitchen includes modern appliances and ample natural light, fostering a social atmosphere. The double bedroom , while the bathroom is fitted with a contemporary style shower, wc and hand wash basin. The apartment has electronic window blinds and will be a great apartment to chill at the end of the day whilst being in close proximity to Central Chester to visit the many local bars and re

L  
E

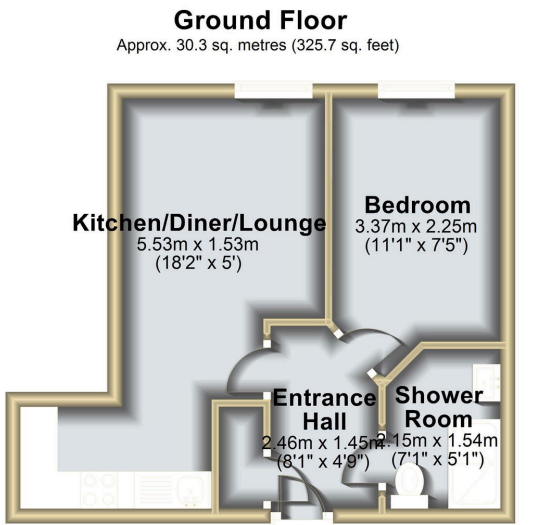

Total area: approx. 30.3 sq. metres (325.7 sq. feet)

