

Tilery Farm, Bleatarn

Offers In Region Of £950,000

🛏️ 6 🚿 3 🚗 2



In a peaceful rural setting set within the stunning Eden Valley, surrounded by fields and countryside, Tilery Farm is an incredible opportunity for buyers looking to make a change or expand on their current lifestyle and even start a new business. The opportunities this home can bring is endless. The Main house, pool/spa complex and outbuildings bring that opportunity along with the grounds and land run to the front and side and encompass a beautiful man made lake - complete with small jetty and visiting wildlife. I promise this location will never disappoint.

- 7 Bedrooms - 2 ensuite
- Rural location
- Business Opportunity
- 18 Acres of land
- Your very own lake
- Set within the Eden Valley with the Yorkshire Dales and Lakes District Close by
- Easy Access to the A66, M6 Junction 40 and The West Coast Mainline for London and Scotland
- Indoor Swimming Pool

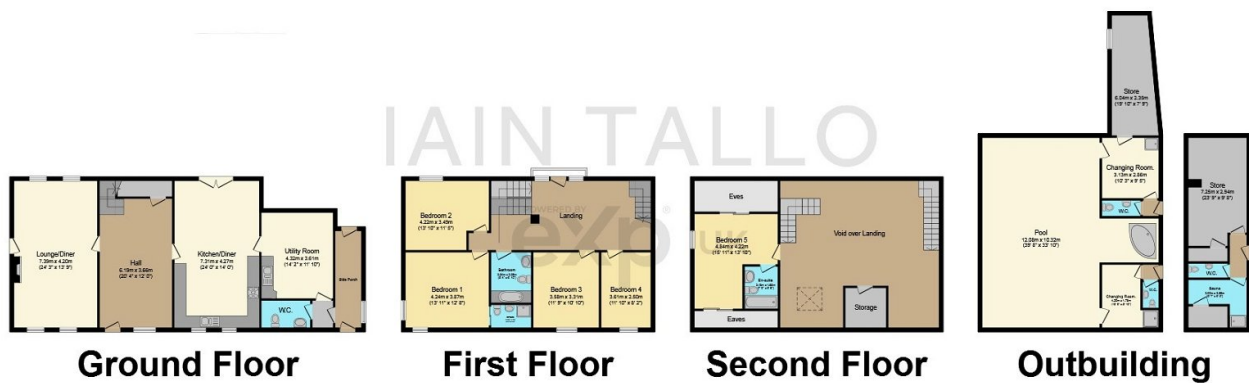

This plan is for illustration purposes only and may not be representative of the property. Plan not to scale. Powered by PropertyBox