





NICK LOATES

POWERED BY
exp UK

52 Park Crescent,

Guide Price £650,000 - £675,000

 3  1  3



- Three Double Bedrooms
- Driveway
- Modern Bathroom
- Large Rear Garden
- Semi Detached
- Extended To The Rear
- Fitted Wardrobes
- Popular Location



Situated on the sought-after Park Crescent in Harrow Weald, this beautifully presented semi-detached family home offers a rare opportunity with three generously sized double bedrooms an uncommon find in the area. Tastefully maintained throughout, the property boasts a spacious and light-filled interior ideal for modern family living. The ground floor features an open-plan living and dining area, enhanced by stylish bifold doors that seamlessly connect the indoors to a large, well-maintained rear garden, perfect for entertaining or enjoying quiet family time. Upstairs, three double bedrooms provide ample space and flexibility for growing families, home working, or guests. The home also benefits from a smartly presented kitchen, modern bathroom, and off-street parking. Located in a quiet, family-friendly neighbourhood with excellent local schools, parks, and transport links nearby, this charming property offers both comfort and convenience in one of Harrow most

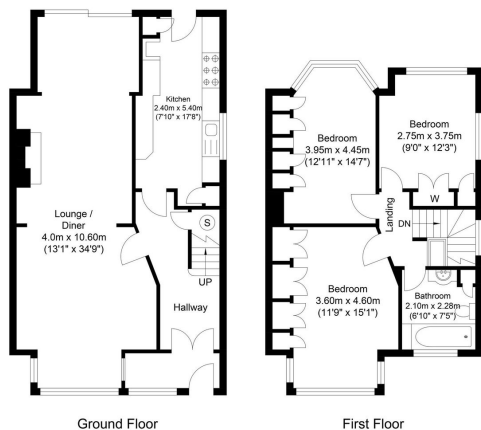

Approx Gross Internal Floor Area : 106.96 sq m. (1151.31 sq. ft.)

