

Bassett Road, W10

Guide Price £850,000

2 1 1



- Please quote MG1175 for all enquiries.
- Large Private Roof Terrace
- 2 Double Bedrooms
- Separate Modern Kitchen
- 1st Floor
- Spacious reception room leading onto the roof terrace
- Quiet Tree Lined Road
- Short walk from Ladbroke Grove tube Station (Circle, Hammersmith & City)
- Close to Portobello Road market
- Beautifully maintained building

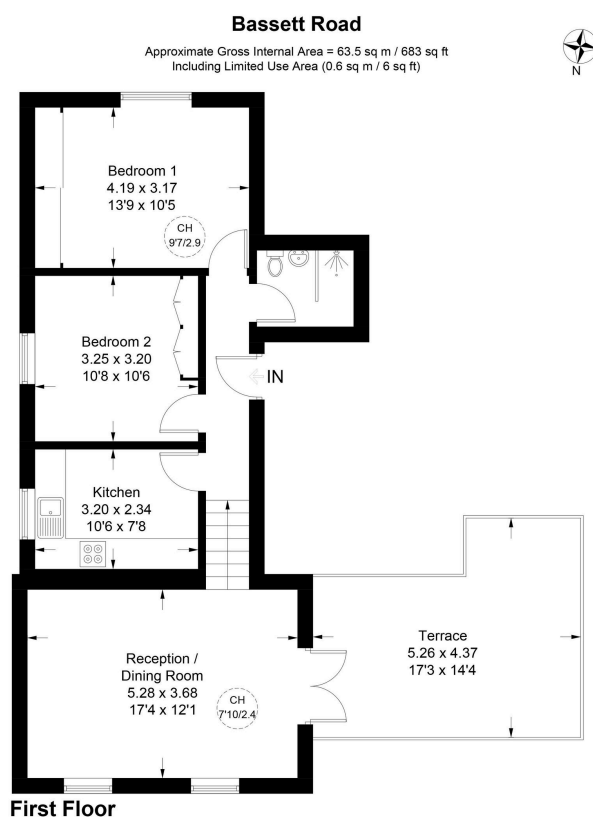

Illustration for identification purposes only, not for valuation purposes, measurements are approximate, not to scale. IPMS2

Please quote MG1175 for all enquiries.

Set within a handsome double-fronted Victorian villa on one of North Kensington's most desirable streets, this beautifully presented first-floor split level flat offers an exceptional private roof terrace with sweeping views over the tranquil rear gardens.