

EUGEN COTORANU

POWERED BY
exp UK

Dowdeswell Close, Putney, SW15 5RP

Offers Over £525,000

🛏 3 🚿 2 🚗 1

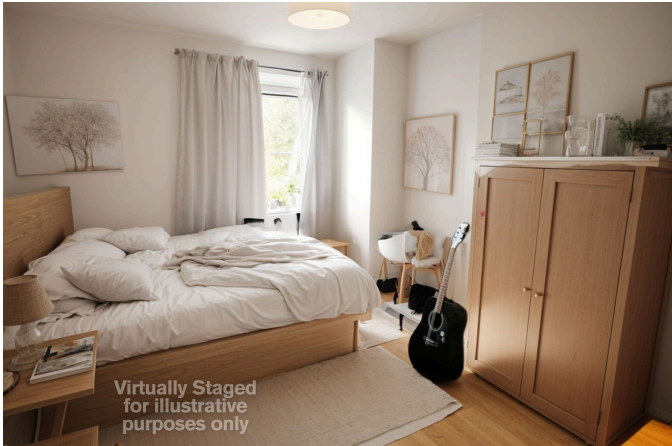

Spacious 3/4-bed freehold home with 1,144 sq ft to live, grow & flourish. Garden, garage, chain free & a blank canvas ready for your personal touch. Guide Price: £525k–£550k.

SELL | BUY | LET | INVEST

07774 807085 | eugen.cotoranu@exp.uk.com

EUGEN COTORANU

POWERED BY
exp UK

- Quote EC0801
- Guide price £525,000 - 550,000 Chain Free
- Borders of Barnes, Putney & East Sheen
- Barnes Train Station - 12 min walk
- Front & Rear Gardens
- Excellent Schools Nearby
- Potential to Extend (STPP)
- 2 Bathrooms
- Garage
- Free Parking

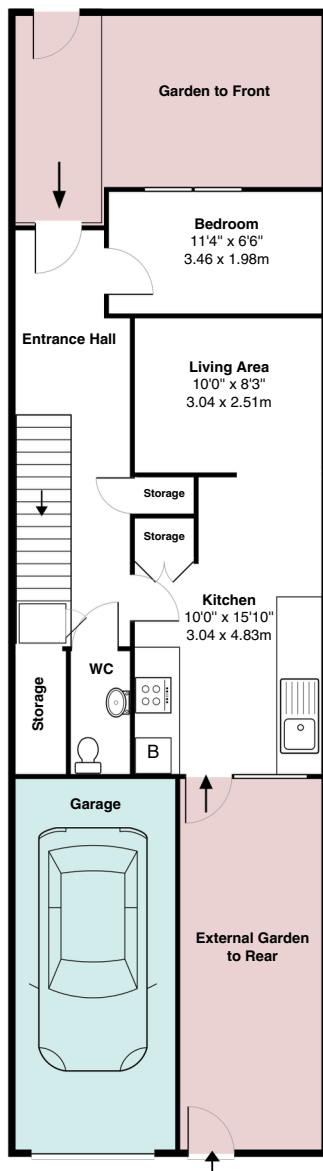

Ground Floor

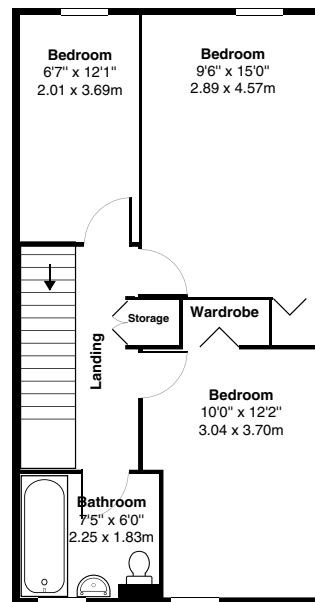

First Floor

DOWDESWELL CLOSE

APPROXIMATE GROSS INTERNAL FLOOR AREA: 990 SQ FT - 92 SQ M

SELL | BUY | LET | INVEST

07774 807085 | eugen.cotoranu@exp.uk.com