

**87 Beechwood Grove,**  
Guide Price £300,000 to £350,000

🛏 2 🚿 1 🚻 1



- Please Quote MG1175 for all enquiries
- Over 55's Later Living Property
- Separate Kitchen
- Onsite Manager on Call
- Private Communal Gardens
- 2 Bed Apartment
- 2nd Floor with Lift Access
- Guide Price: £300,000 to £350,000
- In need of cosmetic refurbishment
- Communal Reception Room

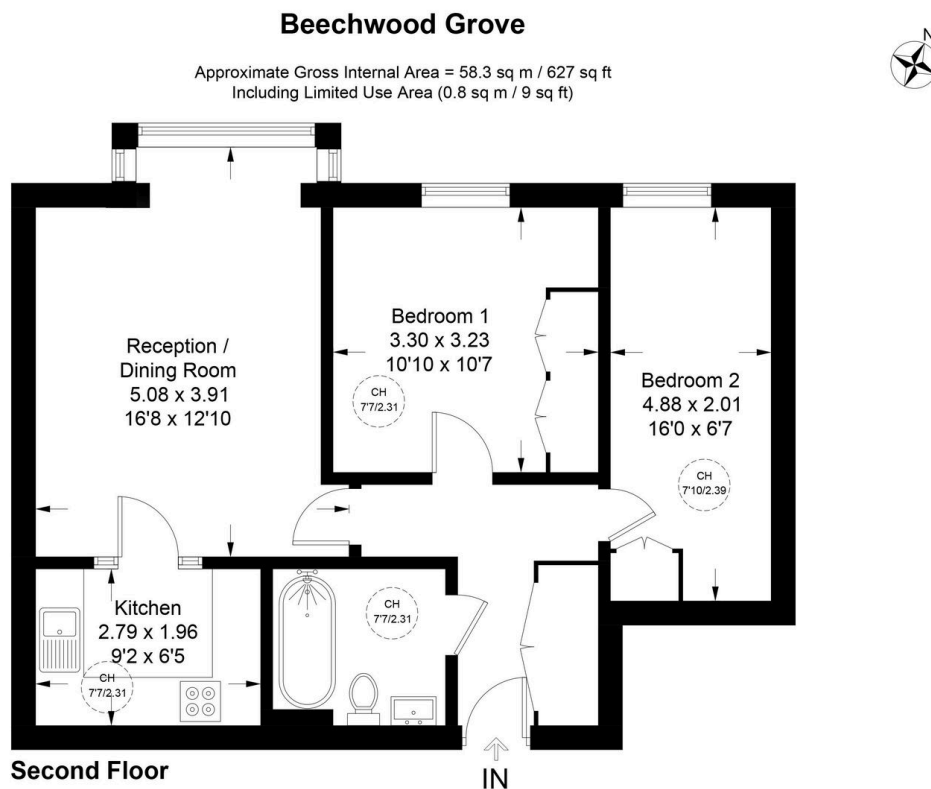

Illustration for identification purposes only, not for valuation purposes, measurements are approximate, not to scale. IPMS2

2-Bedroom Apartment at Beechwood Grove, W3 7HY – Over 55's Later Living. Situated on the second floor of the sought-after Beechwood Grove development, this two-bedroom apartment offers comfortable, later-living accommodation with the benefit of lift access for ease and convenience. The property would benefit from some cosmetic refurbishment, allowing the new owner to personalise the space to their taste. Inside, you'll find two well-proportioned bedrooms, a bright living area, and a functional kitchen and bathroom.