

## Nelson House, Westwick Gardens, W14

£2,200PCM (Deposit: £2,538)

1 1 1



Tax Band: C Furnished: Part Furnished

Please Quote MG1175 for all enquiries

Right in the buzzing heart of Shepherd's Bush, this super stylish 1-bedroom flat on the 2nd floor is the perfect mix of modern vibes and laid-back comfort. Flooded in natural light thanks to its West-facing windows, the open-plan living space is bright, roomy, and ideal for everything from chilling out to entertaining friends. Massive floor-to-ceiling windows and a slick Juliette balcony blur the lines between indoors and out—hello sunset views!

## Key Features

- Please Quote MG1175 for all enquiries
- 1 Double Bedroom
- Open Plan Kitchen/Reception with floor to ceiling windows
- Contemporary Finish Throughout
- 2nd Floor
- Lots of Natural Light
- c. 550 sqft
- Moments from green parks
- Walking distance to multiple transport lines
- Close to shops & restaurants of Westfield Shopping Centre

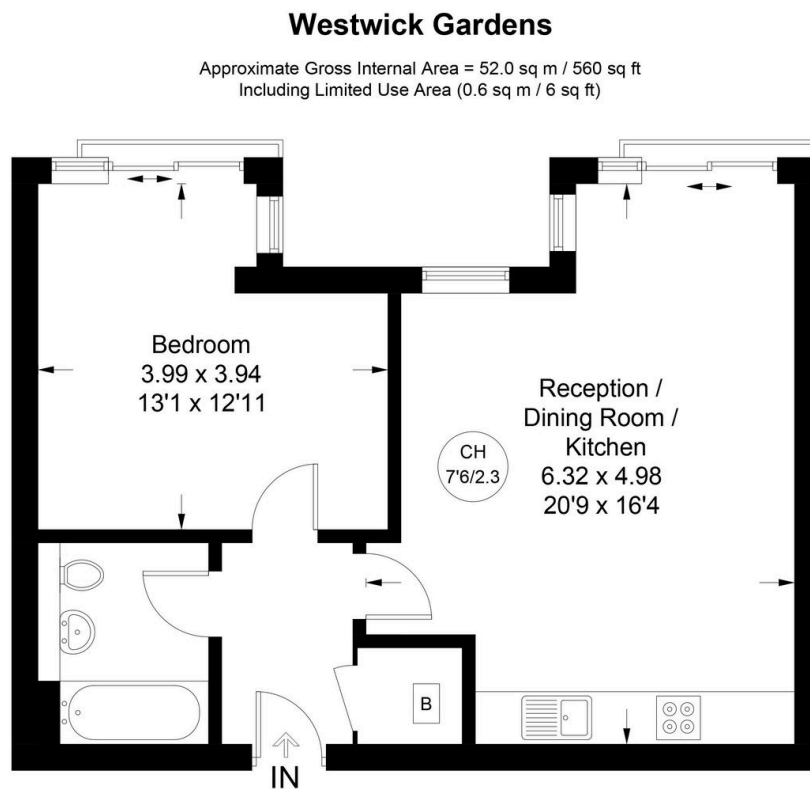

Illustration for identification purposes only, not for valuation purposes, measurements are approximate, not to scale. IPMS2