

Flat 105 Maestro Apartments, 55 Violet Road

Guide Price £425,000 - £450,000

2 1 1



- Please Quote Ref DG0640
- Open Plan
- Balcony
- Great Transport Links
- Onsite Gym with monthly membership
- No Onward Chain
- Two Double Bedrooms
- Communal Roof Terrace
- Close to Green Spaces
- Guide Price £425.000 - £450.000.

Maestro Apartments, E3

Approx. Gross Internal Area
69.8 sq m / 751 sq ft

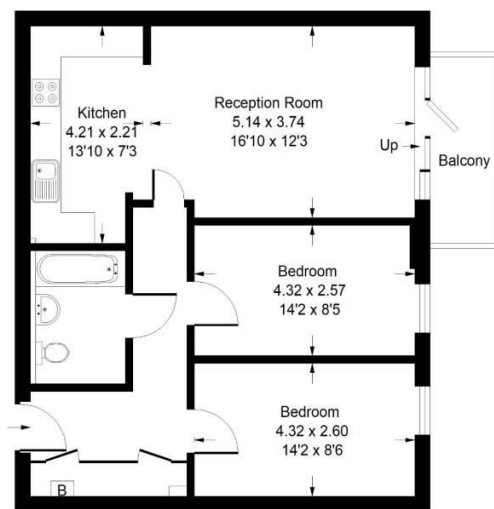

First Floor

Whilst every attempt has been made to ensure the accuracy of the floor plan, measurements are approximate and not to scale. No guarantee is given on the total square footage of the property quoted on the plan. Figures given are for guidance. Plans to be discussed purposes only, not to be used for valuations.

Please Quote Ref DG0640. Guide Price £425.000 - £450.000. Offered with No Onward Chain is this well presented West facing first-floor apartment with Balcony located in the sought-after Caspian Wharf development.

Offering a spacious open plan lounge/kitchen, designed for modern living, with integrated appliances. Both bedrooms are doubles, providing ample space for relaxation and storage, along with a stylish bathroom.

Enjoy the outdoors from your private, West-facing balcony, with views towards Canary Wharf and perfect for your morning coffee or evening drink. The apartment benefits access to a large communal roof terrace with stunning city views, secure bike storage, and an on-site gym (monthly membership fee applies).

Location -This apartment is perfectly situated to take advantage of excellent transport links and local amenities: