

Streatham High Road, Streatham, SW16

Offers Over £350,000

🛏️ 2 🚿 2 🚗 1



PLEASE QUOTE MR0560- Well presented two bedroom, two bathroom, second floor apartment (781 Sq.Ft) with parking space and residents gym, conveniently located in the vibrant heart of Streatham, moments from transport links and amenities. The property has been well maintained and appointed, offering bright, well planned accommodation with modern interiors and neutral finish throughout - ideal for homeowner or investor alike. Features include a light and spacious reception room, separate well equipped kitchen, modern bathroom and principal en-suite, electric heating, double glazing, quality floor coverings and ample inbuilt storage.

Key Features

- PLEASE QUOTE MR0560
- Well Presented Two Bedroom Second Floor Apartment (781 Sq.Ft)
- Fantastic Location in Heart of Streatham
- Bright and Spacious Reception Room
- Separate Well Equipped Kitchen
- Modern Bathroom and Principal En-Suite
- Parking Space and Residents Gym
- No Onward Chain
- Moments from Excellent Transport Links
- Close to Shops, Bars, Restaurants and Amenities

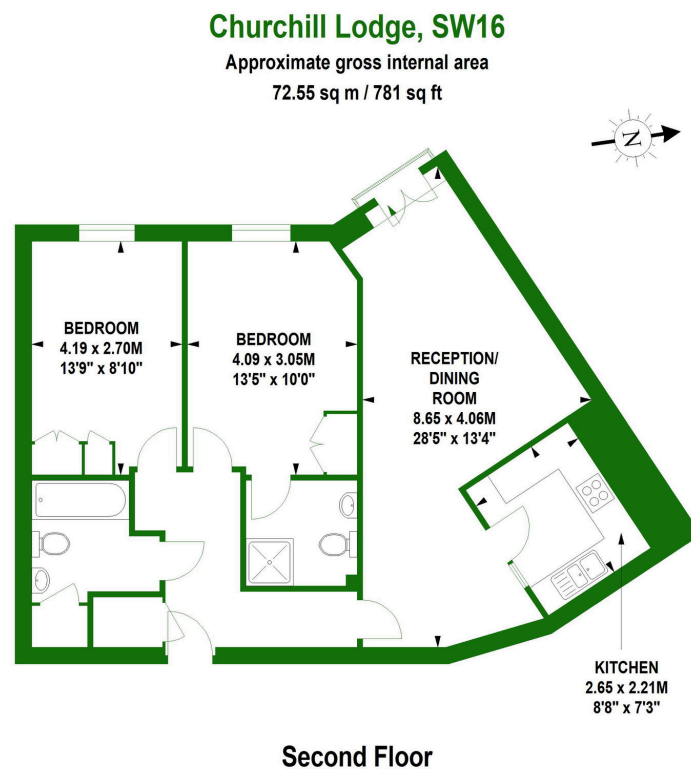

Although every attempt has been made to ensure accuracy, all measurements are approximate.
This floorplan is for illustrative purposes only and not to scale.
Measured in accordance with RICS standards.