

## 406 Kitson House 6 Corsican Square, Bow

Offers Over £425,000

1 1 1



- No Onward Chain
- Secure Underground Parking
- 4th Floor with Lift
- Working Space for Residents
- Open Plan Lounge/kitchen with Integrated Appliances
- Balcony with Views to Canary Wharf
- Quadruple Glazing
- Close to Transport Links

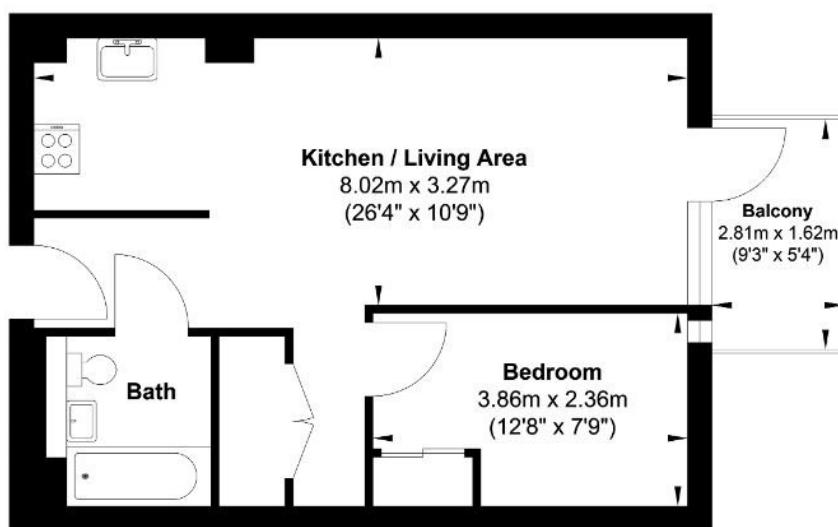

Gross Internal Floor Area : 44.56 m2 ... 479.61 ft2

Whilst every attempt has been made to ensure the accuracy of the floor plan contained here, measurements of doors, windows, rooms and any other items are approximate and no responsibility is taken for any error, omission, or mis-statement. This plan is for illustrative purposes only and should be used as such by any prospective purchaser. The services, systems and appliances shown have not been tested and no guarantee as to their operability or efficiency can be given.

Offered With No Onward Chain. A superb one bedroom open plan apartment, located on the 4th floor (with lift access), a private balcony and secure underground parking. The building also offers a stylish communal work space with Wifi and Bike storage. Located close to transport links, cafes and green spaces.