

EUGEN COTORANU

POWERED BY
exp UK

10 Wainwright Grove, Isleworth, TW7 7PU

£450,000

🛏️ 2 🍴 1 🚗 1



A well-presented, two double bedroom family home. Experience comfort and potential with **PLANNING PERMISSION GRANTED** for a loft extension. Enjoy allocated parking, ample storage, and front & rear gardens. PLEASE QUOTE EC0801

SELL | BUY | LET | INVEST

07774 807085 | eugen.cotoranu@exp.uk.com

EUGEN COTORANU

POWERED BY
exp UK

- PLEASE QUOTE EC0801
- Front & Rear Gardens
- Free Allocated Parking
- Ample Storage Space
- Freehold
- Planning Permission Granted Loft Extension
- Two Spacious Double Bedrooms
- Modern Kitchen & Dining room
- Cul De Sac Location
- Ideal for First Time Buyers

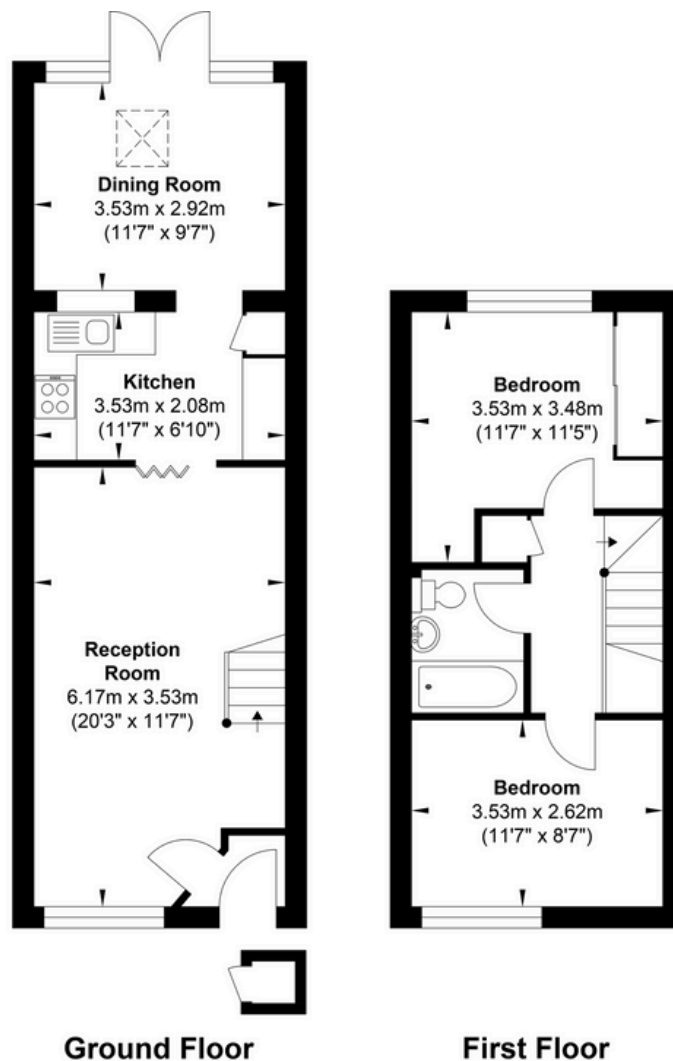

Ground Floor **First Floor**
Gross Internal Floor Area : 72.3 m2 ... 778 ft2

Whilst every attempt has been made to ensure the accuracy of the floor plan contained here, measurements of doors, windows, rooms and any other items are approximate and no responsibility is taken for any error, omission, or mis-statement. This plan is for illustrative purposes only and should be used as such by any prospective purchaser. The services, systems and appliances shown have not been tested and no guarantee as to their operability or efficiency can be given.

SELL | BUY | LET | INVEST

07774 807085 | eugen.cotoranu@exp.uk.com