

King Street, Hammersmith, W6

Guide Price £500,000 - £550,000

1 1 1



PLEASE QUOTE JW0326- GUIDE PRICE £500K - £550K - Very well presented one bedroom first floor apartment (378 Sq.Ft) with private terrace, 990 year lease and no onward chain, ideally situated in a vibrant Hammersmith location, moments from transport links and amenities. The property offers bright, well planned accommodation with modern interiors and quality finish - ideal for first time or investment buyer alike. Features include an inviting open plan reception/ kitchen, modern shower room, electric heating, double glazing, quality floor coverings and neutral decor.

Key Features

- MODERN 1 BED FIRST FLOOR APARTMENT (378 SQ.FT)
- FANTASTIC VIBRANT LOCATION
- STYLISH INTERIORS AND QUALITY FINISH
- MODERN OPEN PLAN LIVING
- PRIVATE TERRACE
- 990 YEAR LEASE
- NO CHAIN
- CLOSE TO HAMMERSMITH STATION
- MOMENTS FROM SHOPS AND AMENITIES
- PLEASE QUOTE JW0326

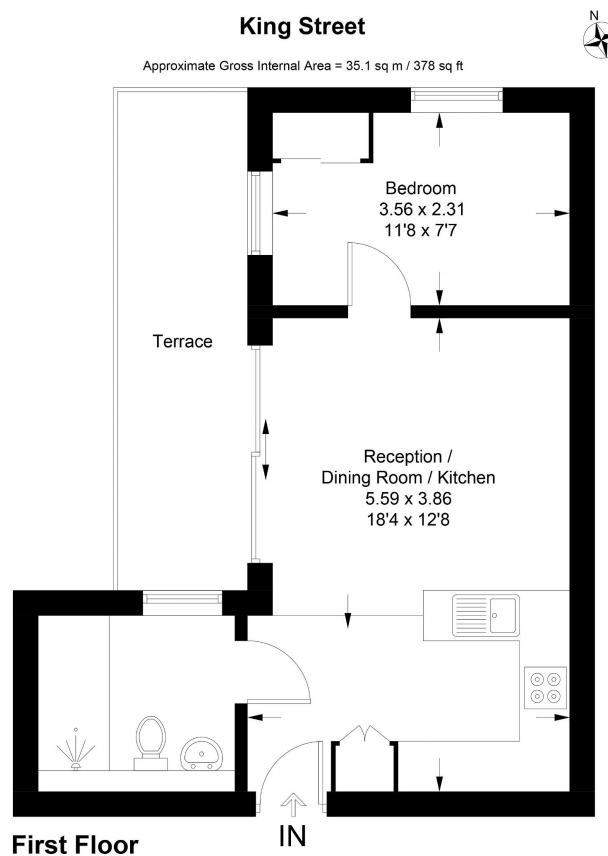

Illustration for identification purposes only, not for valuation purposes.
measurements are approximate, not to scale.