

Artisan Place, Wealdstone, Harrow, HA3 5EB

£325,000

🛏️ 2 🚿 1 🚻 1



- Ground Floor Apartment
- Modern Throughout
- Leasehold
- Two Bedrooms
- Close To Transport Links
- REF/GP0453
-
-

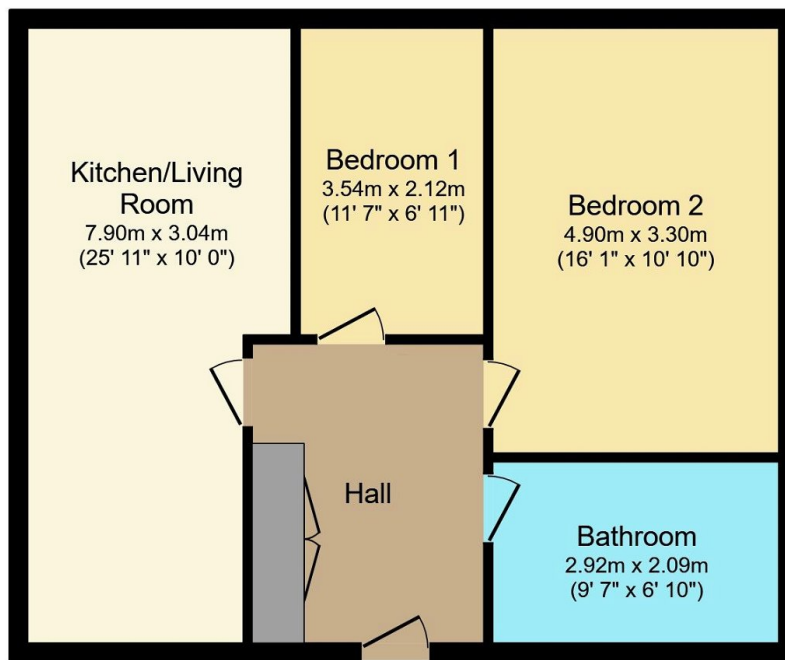

Floor Plan

Total floor area 61.4 m² (661 sq.ft.) approx

This plan is for illustration purposes only and may not be representative of the property. Plan not to scale. Powered by PropertyBox

This two bedroom ground floor apartment is set in the heart of HA3 and sold with no upper chain. The property was built five years ago to a high specification and comprises of an open plan living space/kitchen with built in appliances, two double bedrooms and a large modern bathroom. The accommodation is modern throughout currently rented for £1,600.00pcm with a potential income of £1,800.00pcm and is within walking distance to Harrow & Wealdstone station (Bakerloo and various Overground Services, as well as a number of bus routes).