

Bushey Road, Raynes Park, SW20

£425,000

2 1 1



Well presented two double bedroom second floor flat (827 Sq.Ft), set within a popular purpose built block with attractive communal grounds, residents parking and long lease, ideally located within a short distance of Wimbledon Chase and Raynes Park stations, as well as local amenities. . The property has been well maintained and appointed by the current owner, offering bright and spacious accommodation with period appeal, stylish interiors and neutral decor throughout. Features include a generous reception/dining room, separate well equipped kitchen, bathroom with white suite, gas central heating, double glazing, security entry phone, high ceilings, and quality floor coverings.

Key Features

- Well Presented Two Bedroom Second Floor Flat (827 Sq.Ft)
- Period Appeal and Modern Interiors
- Separate Well Equipped Kitchen
- Residents Parking
- Close to Raynes Park and Wimbledon Chase Stations
- Sought After Development
- Bright and Spacious Reception Room
- Attractive Communal Gardens
- Long Lease
- Property Ref: DA 0587

Merton Mansions
Approx Gross Internal Area
Second Floor = 76.9 Sq m / 827 Sq Ft

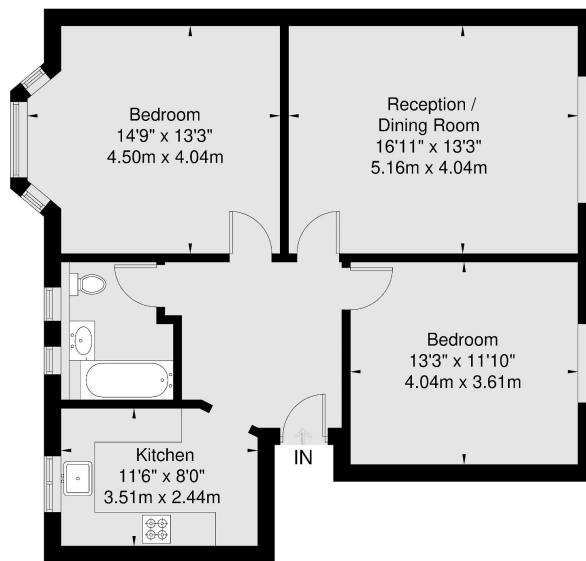

Second Floor

Viewmedia © 2024
Viewmedia.co.uk

Whilst every attempt has been made to ensure the accuracy of this floor plan, measurements of doors, windows and rooms are approximate and no responsibility is taken for any error or omission. This illustration is for identification purpose only. Measured and drawn accordance with RICS guidelines. Not drawn to scale, unless stated. Dimensions shown are to the nearest 3" and are to the points indicated by the arrow heads.