



JOSE BILAO

POWERED BY
exp UK

INDEPENDENT ESTATE AGENT
Buying, Selling, Renting, Investing

Imperial Wharf, London, SW6

Guide Price £750,000

🛏️ 2 🚿 2 🚗 1



- Please Quote JD0696 For All Enquires
- Two Bedroom
- Two Bathroom
- Lift Access
- 24h Conceirge and Gym
- Riverside Development
- Underground Parking Bay Included
- High Specification
- Private Balcony
- Fourth Floor



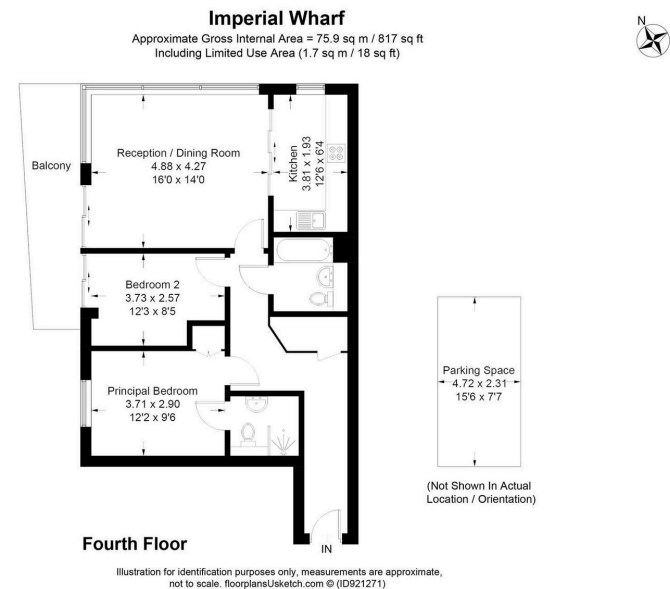

This exquisite two-bedroom luxury apartment on the fourth floor offers a stunning view over a peaceful courtyard and fountain towards Fulham. Impeccably presented, it features a private balcony, two elegant bathrooms, and a well-appointed kitchen. Finished to the highest standards, it includes air conditioning and tiled floors.

Set within a secure building in the sought-after Imperial Wharf riverside development, the apartment grants access to a wealth of on-site amenities, including restaurants, pubs, gardens, and a fully equipped gym. With natural light flooding the reception, an inviting living space, and a modern kitchen, this residence is perfect for unwinding and entertaining.

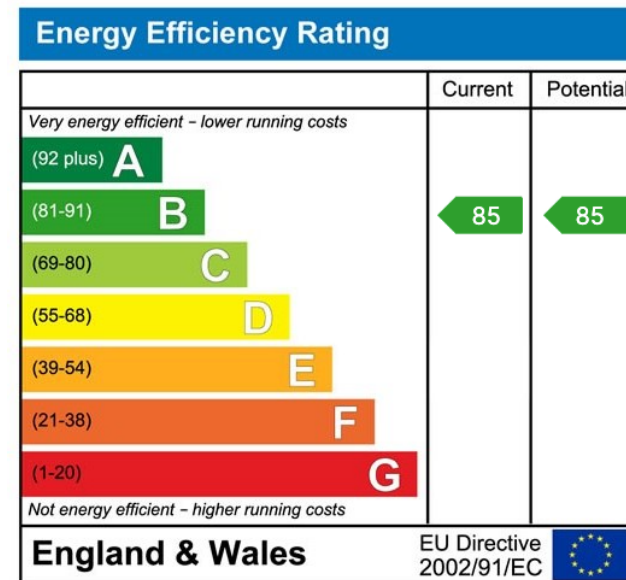

JOSE BILAO
 POWERED BY **exp** UK

INDEPENDENT ESTATE AGENT
 Buying, Selling, Renting, Investing