

31 Sundale Avenue,
£435,000

3 1 1

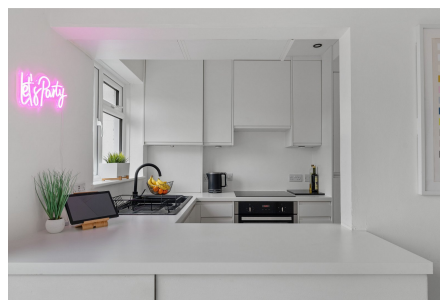

This lovely, 3 bedroom terrace house in the heart of Selsdon is the perfect purchase for first time buyers or even someone looking to downsize.

The property boasts, off street parking, modern kitchen and bathroom, nicely decorated throughout and the added bonus of being just a few minutes walk to the high street and a handful of good primary schools.

There is also regular bus service runs close by, direct to Croydon town centre and main line station.

Key Features

-
-
-
-
-
-

GROUND FLOOR
453 sq.ft. (42.1 sq.m.) approx.

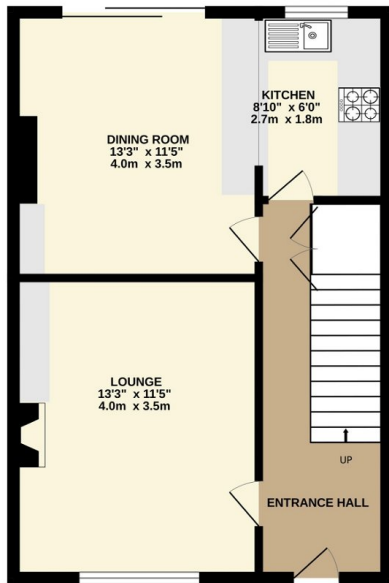

1ST FLOOR
454 sq.ft. (42.2 sq.m.) approx.

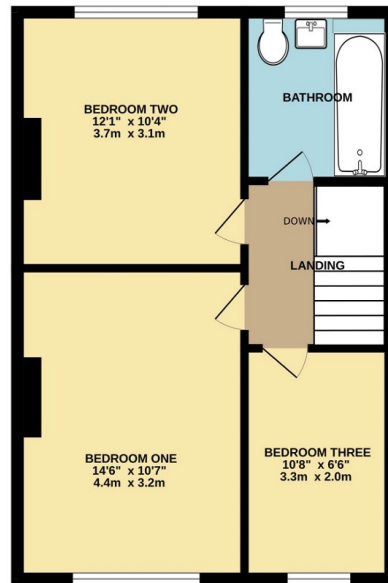

TOTAL FLOOR AREA: 908 sq.ft. (84.3 sq.m.) approx.

Whilst every attempt has been made to ensure the accuracy of the floorplan contained here, measurements of doors, windows, rooms and any other items are approximate and no responsibility is taken for any error, omission or mis-statement. This plan is for illustrative purposes only and should be used as such by any prospective purchaser. The services, systems and appliances shown have not been tested and no guarantee as to their operability or efficiency can be given.
Made with Metropix ©2024