

Kings Avenue, Clapham, SW4

Guide Price £550,000

🛏️ 2 🚿 1 🚻 1



PLEASE QUOTE JW0326 - Occupying a sought after location on the borders of Clapham and Brixton, this beautifully presented two double bedroom ground floor apartment (711 Sq.Ft) with large private garden, set within a converted police building with blue windows reflecting the heritage of the property. Offering well planned accommodation with stylish interiors and neutral finish throughout, the property represents an ideal purchase for homeowner or investor alike in this fantastic residential location. Features include an inviting reception room with direct access onto the private garden - ideal for al fresco entertaining - separate well equipped kitchen, modern bathroom and separate WC, ample inbuilt storage, gas central heating, double glazing, intruder alarm, communal gardens and residents' permit parking.

Key Features

- BEAUTIFUL 2 BED GROUND FLOOR APARTMENT (711 SQ.FT)
- STYLISH INTERIORS AND QUALITY FINISH THROUGHOUT
- SEPARATE WELL EQUIPPED KITCHEN
- LARGE PRIVATE GARDEN, RESIDENTS PERMIT PARKING
- CLOSE TO TRANSPORT LINKS AND AMENITIES
- SOUGHT AFTER CLAPHAM/BRIXTON BORDERS LOCATION
- BRIGHT AND SPACIOUS RECEPTION ROOM
- MODERN BATHROOM/SEPARATE WC
- COMMUNAL GARDENS
- PLEASE QUOTE JW0326

Kings Avenue

Approximate Gross Internal Area = 66.1 sq m / 711 sq ft

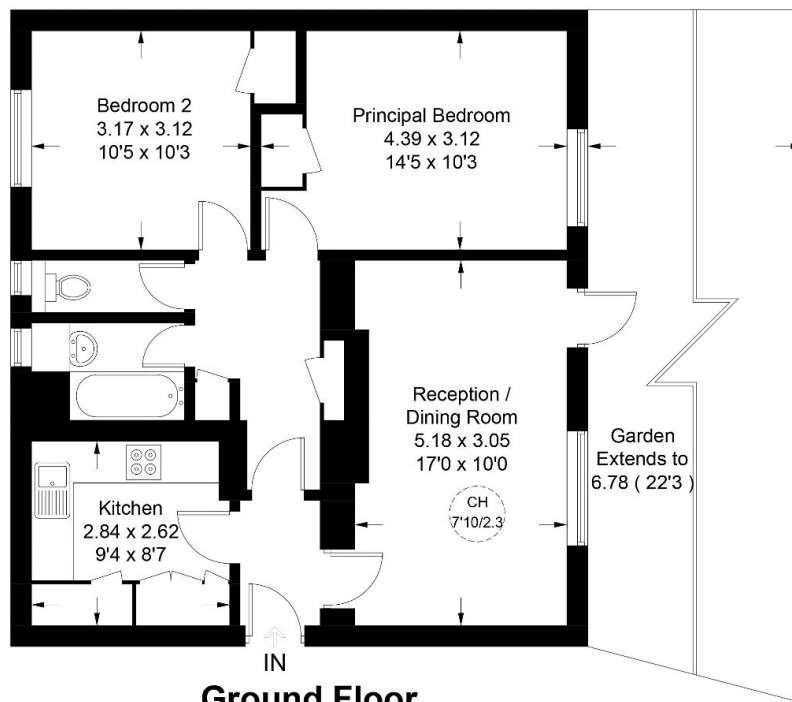

Ground Floor

Illustration for identification purposes only, not for valuation purposes, measurements are approximate, not to scale.