

Battersea Exchange, Brogan House, SW8

GUIDE PRICE £600,000 - £650,000

🛏 1 🚿 1 🛋 1



PLEASE QUOTE JW0326 - GUIDE PRICE £600K - £650k - Superbly situated in the highly sought after Battersea Exchange development, this stylishly presented one bedroom ninth floor apartment (591 Sq.Ft) boasting a delightful enclosed winter garden and long (993 year) lease. The property has been well maintained by the current owners, offering bright, well planned accommodation with modern interiors throughout. Features include a light and airy open plan reception/kitchen, modern bathroom, inbuilt storage, quality floor coverings, district heating and double glazing. The development provides an array of resident facilities, including lift service, 24 hour concierge, gym, communal gardens and excellent on-site amenities including a Sainsbury's supermarket, coffee shops and eateries.

Key Features

- STYLISH 1 BED 9TH FLOOR APARTMENT (591 SQ.FT)
- PRIME BATTERSEA LOCATION
- ENCLOSED WINTER GARDEN
- ONSITE FACILITIES
- MOMENTS FROM BATTERSEA PARK STATION
- SOUGHT AFTER BATTERSEA EXCHANGE DEVELOPMENT
- MODERN OPEN PLAN LIVING
- 24 HOUR CONCIERGE AND RESIDENTS' GYM
- LONG (993 YEAR) LEASE
- PLEASE QUOTE JW0326

ST JOSEPHS STREET, SW8

Approx. Gross Internal Floor Area

591 Sq. ft/54.95 Sq. m (incl. Winter Garden)

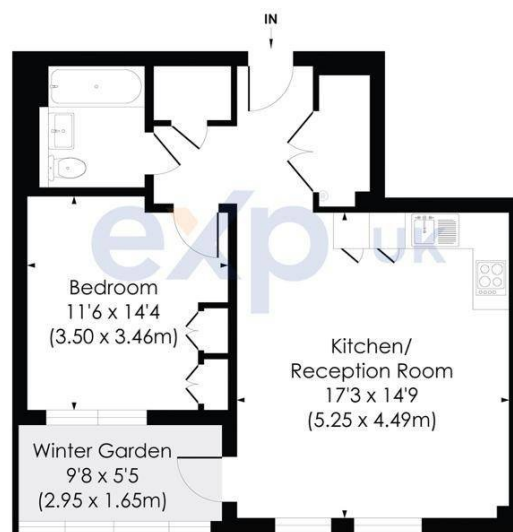

NINTH FLOOR

pixangle
PROPERTY MARKETING

© Pixangle Property Marketing Ltd. info: @pixangle.com Tel: 0208 870 2118
This floor plan has been prepared for illustration purposes only, in accordance with the latest RICS Code of measuring and is not to scale.
All measurements and areas are approximate and whilst every effort has been made to ensure the accuracy of the plan contained here, no responsibility is taken for any error, omission or misstatement.