



**3 Reindeer Court, ,**

**£775,000**

 5  3  2



Set in a private, end of cul-de-sac location, this stunning 5 double bedroom (2 with ensuites,) detached family home boasts generous living accommodation, to include 3 reception rooms, detached double garage & corner plot garden. Simply must be seen to appreciate size & condition.

M: 07970663757

E: martin.drew@exp.uk.com

W: www.martin.drew.exp.uk.com



## Key Features

- 5 bedrooms
- family bathroom
- utility room
- study
- corner plot garden
- 2 ensuite bathrooms
- kitchen/dining/family room
- living room
- double garage with parking
- private, end of cul de sac location

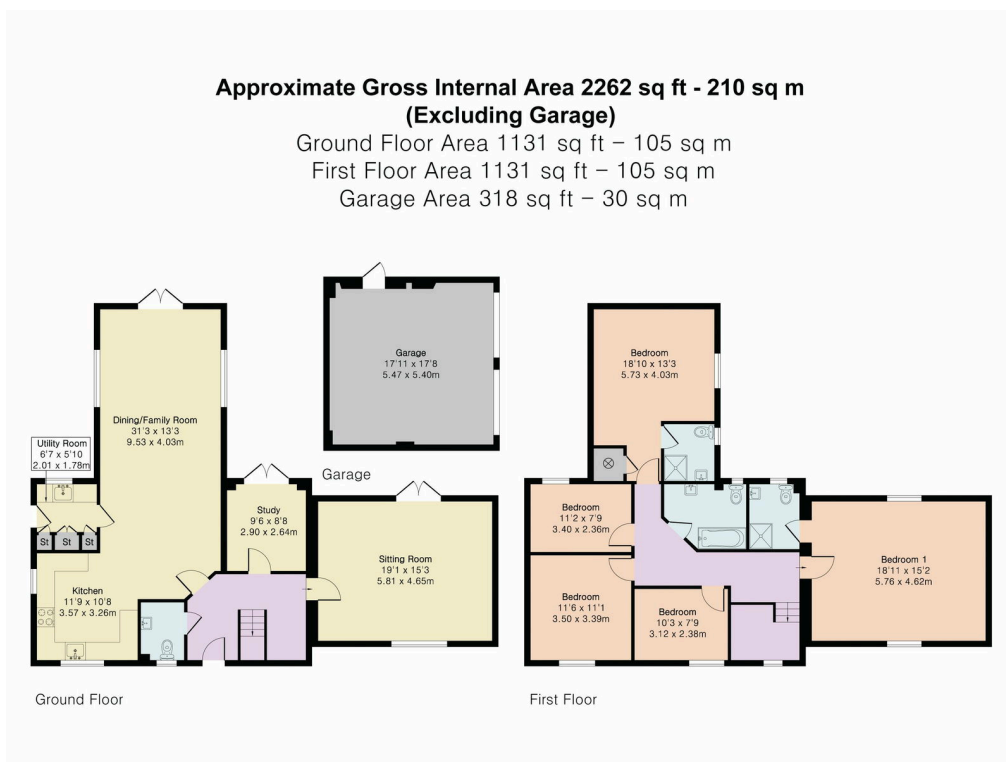

Floor plan produced in accordance with RICS Property Measurement 2nd Edition. Although Pink Plan Ltd ensures the highest level of accuracy, measurements of doors, windows and rooms are approximate and no responsibility is taken for error, omission or misstatement. These plans are for representation purposes only and no guarantee is given on the total square footage of the property within this plan. The figure icon is for initial guidance only and should not be relied on as a basis of valuation.

