



JON-PAUL BRAMPTON POWERED BY exp TM UK

@jon-paul.brampton@exp.uk.com

🌐 jonpaulbrampton.exp.uk.com

☎ 07359 015 020

Campbell Land, Pitstone, Buckinghamshire

Guide Price £450,000

🛏 4 🚿 2 🚺 1



- Immaculate finish throughout • Four bedrooms
- Stunning main bedroom suite • Ensuite
- Allocated parking • Landscaped garden
- Village location • Full Fibre Broadband
- Watch the video tour! • Please quote JB0294 when enquiring through Rightmove, Zoopla or OnTheMarket



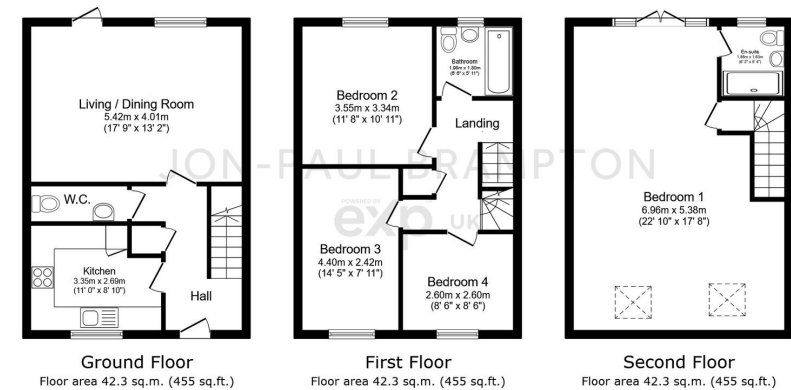

Total floor area: 126.9 sq.m. (1,366 sq.ft.)

This floor plan is for illustrative purposes only. It is not drawn to scale. Any measurements, floor areas (including any total floor area), openings and orientations are approximate. No details are guaranteed, they cannot be relied upon for any purpose and do not form any part of any agreement. No liability is taken for any error, omission or misstatement. A party must rely upon its own inspection(s). Powered by www.propertybox.io

Jon-Paul Brampton presents....space, style and finish in this immaculately presented Pitstone home.

Energy performance certificate (EPC)			
12 Campbell Lane Pitstone LE19 5LQ	<div>Energy rating</div> <div>C</div>	Valid until:	11 May 2033
		Certificate number:	2601-8343-1125-01-01-1342
Property type		Mid-terrace house	
Total floor area		115 square metres	
Rules on letting this property			
Properties can be let if they have an energy rating from A to E.			
You can read guidance for landlords on the regulations and exemptions here			

eXp World UK Ltd is a registered company at Level 37, 25 Canada Square, London, E14 5LQ.
Registered company number is 12016573. VAT Registration Number is 327 4120 29