



JON-PAUL BRAMPTON POWERED BY **exp** TM UK

@jon-paul.brampton@exp.uk.com

 jonpaulbrampton.exp.uk.com

 07359 015 020

Toms Hill Road, Aldbury, Hertfordshire

Offers Over £475,000

2 1 2



- Watch the video tour
- Period charm
- Sensational views
- Large garden
- Two double bedrooms
- Please quote JB0294 when enquiring thru Zoopla, Rightmove or OnTheMarket
- Stunning Aldbury village setting
- Off street parking for 3 cars
- Garden office
- Victorian Cottage



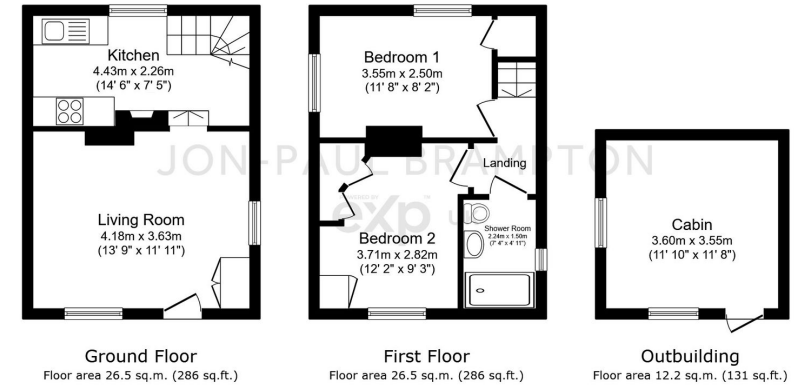

Total floor area: 65.2 sq.m. (702 sq.ft.)

This floor plan is for illustrative purposes only. It is not drawn to scale. Any measurements, floor areas (including any total floor area), openings and orientations are approximate. No details are guaranteed, they cannot be relied upon for any purpose and do not form any part of any agreement. No liability is taken for any error, omission or misstatement. A party must rely upon its own inspection(s). Powered by www.Propertybox.io

Jon-Paul Brampton presents...Victorian Cottage with parking, views and a large garden in the picturesque village of Aldbury.

Energy performance certificate (EPC)			
3 Soma Hill Road Aldbury Herts SG8 WF3 5DA	Energy rating D	Valid until:	27 March 2029
		Certificate number:	2285-1001-5287-3887-1286
Property type		end-terrace house	
Total floor area		50 square metres	
Rules on letting this property			
Properties can be let if they have an energy rating from A to E.			
You can read guidance for landlords on the regulations and exemptions https://www.gov.uk/guidance/domestic-private-rented-property-minimum-energy-efficiency-standard-landlord-guidance			

eXp World UK Ltd is a registered company at Level 37, 25 Canada Square, London, E14 5LQ.
Registered company number is 12016573. VAT Registration Number is 327 4120 29