



CHRIS DURRANT

POWERED BY
exp™
UK

@ chris.durrant@exp.uk.com

chrisdurrant.exp.uk.com

☎ 07595 473 891

Harlow Crescent, Oxley Park, Milton Keynes, MK4 4JA

£140,000

🛏 4 🚿 3 🚗 2

- No upward chain
- Study
- 35% shared ownership home
- £5000 premium
- For all enquiries please quote CD0104
- Four bedroom home
- En suite to master
- Sought after area
- Kitchen/dining room



Being sold with no upward chain is this superb four bedroom home in Oxley Park, Milton Keynes. Situated in a sought after area, and an excellent size family home, this property comprises an entrance hall with storage cupboard and cloak room, kitchen/breakfast room, study/dining room, first floor that has a sitting room and master bedroom with en suite, on the second floor is three further bedrooms and the family bathroom. To the rear is a low maintenance rear garden with two parking spaces and to the front is a garden area. This home is a short walk from shops, schools and green space.

This home is being sold on the shared ownership scheme at 35% ownership. The seller is asking for a premium of £5000.

For all enquiries please quote CD0104



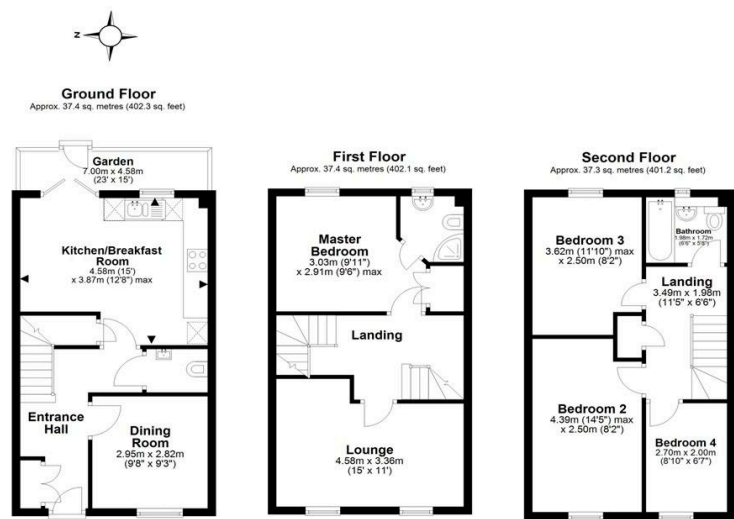

Total area: approx. 112.0 sq. metres (1205.6 sq. feet)

Whilst every attempt has been made to ensure the accuracy of the floor plans, measurements of doors, windows and rooms are approximate and no responsibility is taken for any error, omission or mis-statement. The plans are for representation purposes only as defined by RICS Code of Measuring Practice and should be used as such by any prospective purchaser / tenant. The service, systems and appliances listed in this specification have not been tested by Oliver Remnalls or any representative of Oliver Remnalls and no guarantee as to their operating ability or their efficiency can be given. Copyright: Oliver Remnalls Date Prepared - January 2025



eXp World UK Ltd is a registered company at Level 37, 25 Canada Square, London, E14 5LQ.

Registered company number is 12016573. VAT Registration Number is 327 4120 29