



POWERED BY
exp® UK

49 Roberts Drive, Graven Hill

Offers Over £700,000

🛏 5 🚿 3 🚗 2



Reference MD0803

A truly unique five-bedroom, detached, family home set in a favourable position within the sought-after Graven Hill community. Built and designed by the current owners in 2019, this property blends traditional construction with stylish, modern design throughout.

The accommodation extends to over 2,500 square feet over three floors with well-proportioned rooms benefitting from triple glazing and high-levels of insulation. The ground floor comprises a large hallway, a spacious sitting room, a combined kitchen-dining room, and a utility room with an adjoining cloakroom. Five bedrooms are spread over the first and second floors with a sizeable principal bedroom offering a walk-in wardrobe and an en-suite bathroom. The garden has been landscaped as lawn with mature borders, a patio, and a large garden shed. There is also a driveway with parking for two vehicles and nearby on-street parking.

Area

Graven Hill is a popular new community located at the south edge of Bicester, approximately 13 miles from Oxford and 24 miles from Milton Keynes. It is made up of self-build and custom-build homes surrounded by green, open space and includes a new primary school, coffee shop, shop, wine and cocktail bar, dental surgery, and multiple play areas.

Bicester is one of the fastest-growing areas in Oxfordshire with excellent transport links by rail and road to London, Oxford, Milton Keynes, and Birmingham.



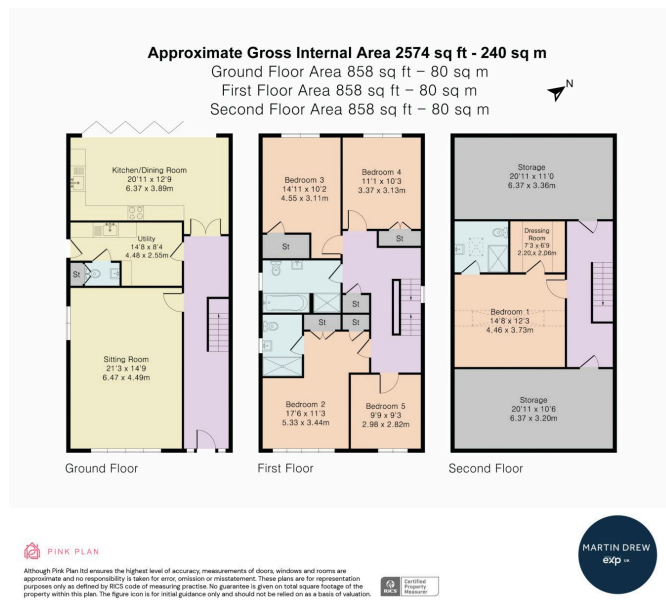

- Five bedrooms with two en-suites
- Principal bedroom with en-suite bathroom and walk-in wardrobe
- Sitting room with log burner
- Utility room with adjoining cloakroom
- Driveway with parking for two vehicles (including electric charging point)
- Four-piece family bathroom
- Combined kitchen-dining room with bi-folding doors
- Large hallway with solid oak staircase
- Underfloor heating on the ground floor
- South-westerly facing garden

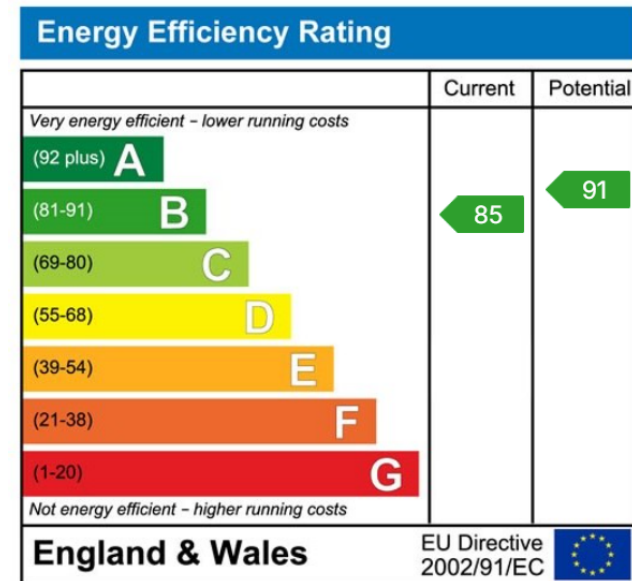

M: 07970663757

E: martin.drew@exp.uk.com

