

CARL MYERS



BESPOKE ESTATE AGENT



See More Online

KFB: Key Facts For Buyers

A Guide to This Property & the Local Area

Sunday 16th February 2025



RODGATE CLOSE, BOUGHTON, NORTHAMPTON, NN2

Carl Myers Bespoke Estate Agent powered by eXp

Kettering

07867 528633/01536 903036

carl.myers@exp.uk.com

www.carlmyers.co.uk

Powered by
aprift
Know any property instantly

Introduction

Our Comments

CARL MYERS



BESPOKE ESTATE AGENT

Introducing "Be Better Informed" – A New Service from Carl Myers Bespoke Estate Agent

At Carl Myers Bespoke Estate Agent, we believe that as a buyer, you deserve to have all the property facts at your fingertips. That's why we've launched "Be Better Informed," our brand-new service designed to give you comprehensive property insights.

Explore our fully interactive property brochures, packed with all the essential information you need:

- ▣ Detailed property boundaries, plot sizes, and square footage.
- ▣ Nearby schools and their ratings.
- ▣ Proximity to the nearest bus stops and other transportation options.
- ▣ Broadband speeds, mobile phone coverage, and available satellite/TV services.

With "Be Better Informed," you can make confident, well-informed decisions about your next home. If there's any additional information you need and can't find in the brochure, please don't hesitate to reach out to us. Call us at 01536 903036, WhatsApp or text us at 07867 528633, or email us at carl@carlmyers.co.uk.

Property Overview

CARL MYERS



BESPOKE ESTATE AGENT

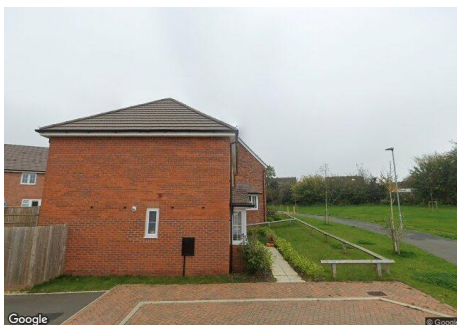

Property

Type:	Detached	Tenure:	Freehold
Bedrooms:	4		
Floor Area:	1,399 ft ² / 130 m ²		
Plot Area:	1.61 acres		
Council Tax :	Band E		
Annual Estimate:	£2,750		
Title Number:	NN393650		

Local Area

Local Authority:	West northamptonshire	Estimated Broadband Speeds (Standard - Superfast - Ultrafast)		
Conservation Area:	No			
Flood Risk:				
● Rivers & Seas	No Risk	9	40	1000
● Surface Water	Very Low	mb/s	mb/s	mb/s
Mobile Coverage: (based on calls indoors)		Satellite/Fibre TV Availability:		

Multiple Freehold Title Plans Detected

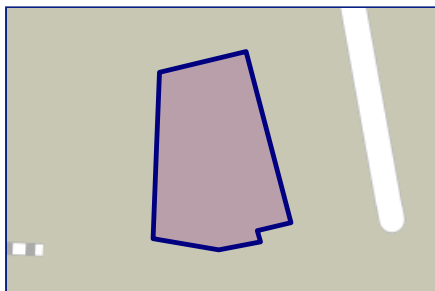

NN390163

Multiple Freehold Title Plans Detected

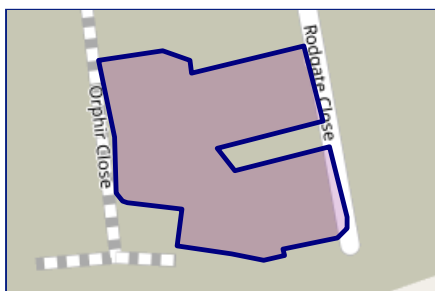

NN393650

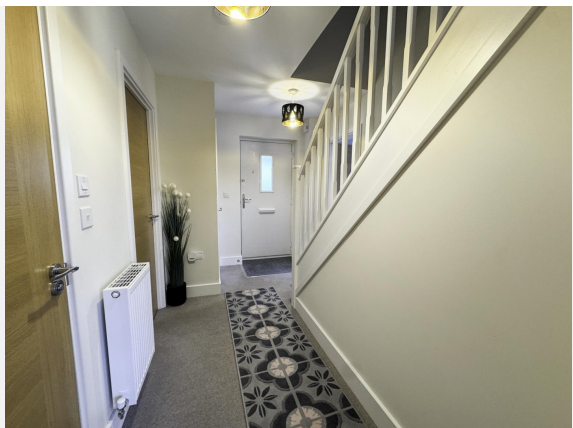

Gallery Photos

CARL MYERS



BESPOKE ESTATE AGENT









RODGATE CLOSE, BOUGHTON, NORTHAMPTON, NN2

GROUND FLOOR
857 sq.ft. (79.6 sq.m.) approx.

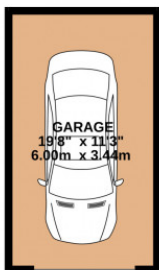

1ST FLOOR
621 sq.ft. (57.7 sq.m.) approx.

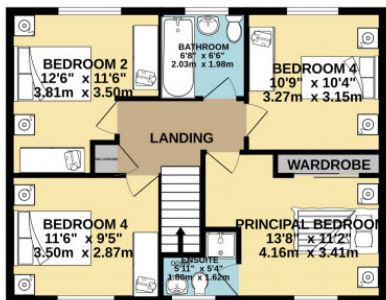

TOTAL FLOOR AREA: 1478 sq.ft. (137.3 sq.m.) approx.

Whilst every attempt has been made to ensure the accuracy of the floorplan contained here, measurements of doors, windows, rooms and any other items are approximate and no responsibility is taken for any error, omission or mis-statement. This plan is for illustrative purposes only and should be used as such by any prospective purchaser. The services, systems and appliances shown have not been tested and no guarantee as to their operability or efficiency can be given.
Made with Metropix ©2025

Property

EPC - Certificate

CARL MYERS



BESPOKE ESTATE AGENT

Boughton, NN2

Energy rating

B

Valid until 29.08.2032

Score	Energy rating	Current	Potential
92+	A		94 A
81-91	B	85 B	
69-80	C		
55-68	D		
39-54	E		
21-38	F		
1-20	G		

Property

EPC - Additional Data

CARL MYERS



BESPOKE ESTATE AGENT

Additional EPC Data

Property Type:	House
Build Form:	Detached
Transaction Type:	New dwelling
Energy Tariff:	Standard tariff
Main Fuel:	Gas: mains gas
Flat Top Storey:	No
Top Storey:	0
Previous Extension:	0
Open Fireplace:	0
Walls:	Average thermal transmittance 0.25 W/m ² ·K
Walls Energy:	Very Good
Roof:	Average thermal transmittance 0.11 W/m ² ·K
Roof Energy:	Very Good
Main Heating:	Boiler and radiators, mains gas
Main Heating Controls:	Time and temperature zone control
Hot Water System:	From main system
Hot Water Energy Efficiency:	Good
Lighting:	Low energy lighting in all fixed outlets
Floors:	Average thermal transmittance 0.15 W/m ² ·K
Total Floor Area:	130 m ²

Area Schools

CARL MYERS



BESPOKE ESTATE AGENT

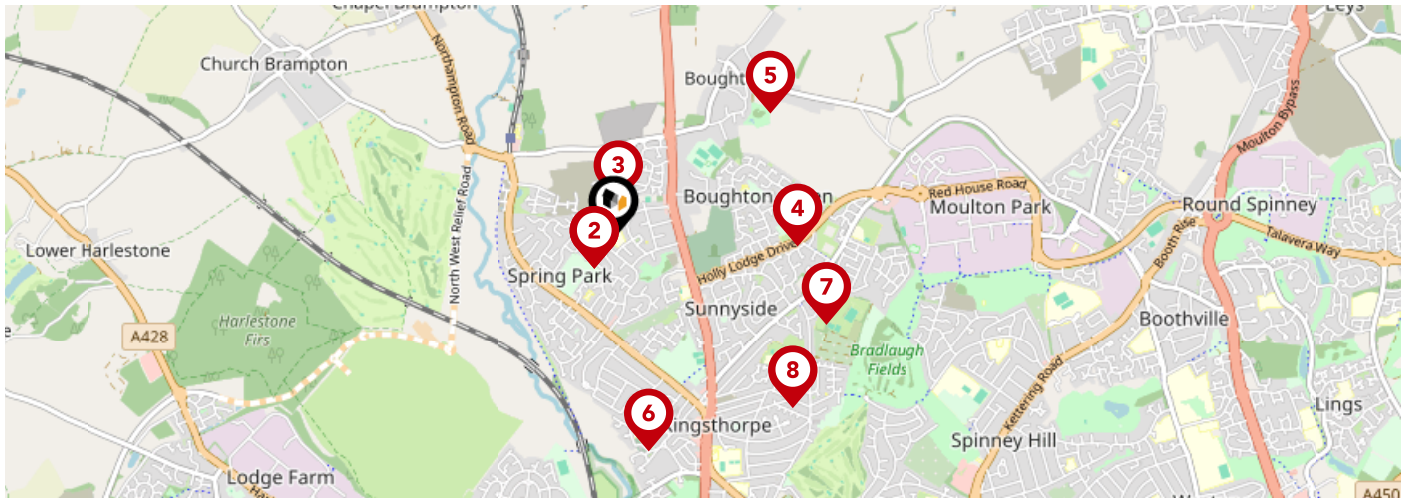

		Nursery	Primary	Secondary	College	Private
1	Whitehills Nursery School Ofsted Rating: Good Pupils: 45 Distance:0.16	<input checked="" type="checkbox"/>	<input type="checkbox"/>	<input type="checkbox"/>	<input type="checkbox"/>	<input type="checkbox"/>
2	Whitehills Primary School Ofsted Rating: Outstanding Pupils: 417 Distance:0.16	<input type="checkbox"/>	<input checked="" type="checkbox"/>	<input type="checkbox"/>	<input type="checkbox"/>	<input type="checkbox"/>
3	Buckton Fields Primary School Ofsted Rating: Not Rated Pupils: 168 Distance:0.16	<input type="checkbox"/>	<input checked="" type="checkbox"/>	<input type="checkbox"/>	<input type="checkbox"/>	<input type="checkbox"/>
4	Sunnyside Primary Academy Ofsted Rating: Good Pupils: 376 Distance:0.84	<input type="checkbox"/>	<input checked="" type="checkbox"/>	<input type="checkbox"/>	<input type="checkbox"/>	<input type="checkbox"/>
5	Boughton Primary School Ofsted Rating: Good Pupils: 197 Distance:0.91	<input type="checkbox"/>	<input checked="" type="checkbox"/>	<input type="checkbox"/>	<input type="checkbox"/>	<input type="checkbox"/>
6	Kingsthorpe Village Primary School Ofsted Rating: Good Pupils: 210 Distance:0.98	<input type="checkbox"/>	<input checked="" type="checkbox"/>	<input type="checkbox"/>	<input type="checkbox"/>	<input type="checkbox"/>
7	Kingsthorpe College Ofsted Rating: Good Pupils: 1403 Distance:1.04	<input type="checkbox"/>	<input type="checkbox"/>	<input checked="" type="checkbox"/>	<input type="checkbox"/>	<input type="checkbox"/>
8	Green Oaks Primary Academy Ofsted Rating: Good Pupils: 236 Distance:1.12	<input type="checkbox"/>	<input checked="" type="checkbox"/>	<input type="checkbox"/>	<input type="checkbox"/>	<input type="checkbox"/>

Area Schools

CARL MYERS



BESPOKE ESTATE AGENT

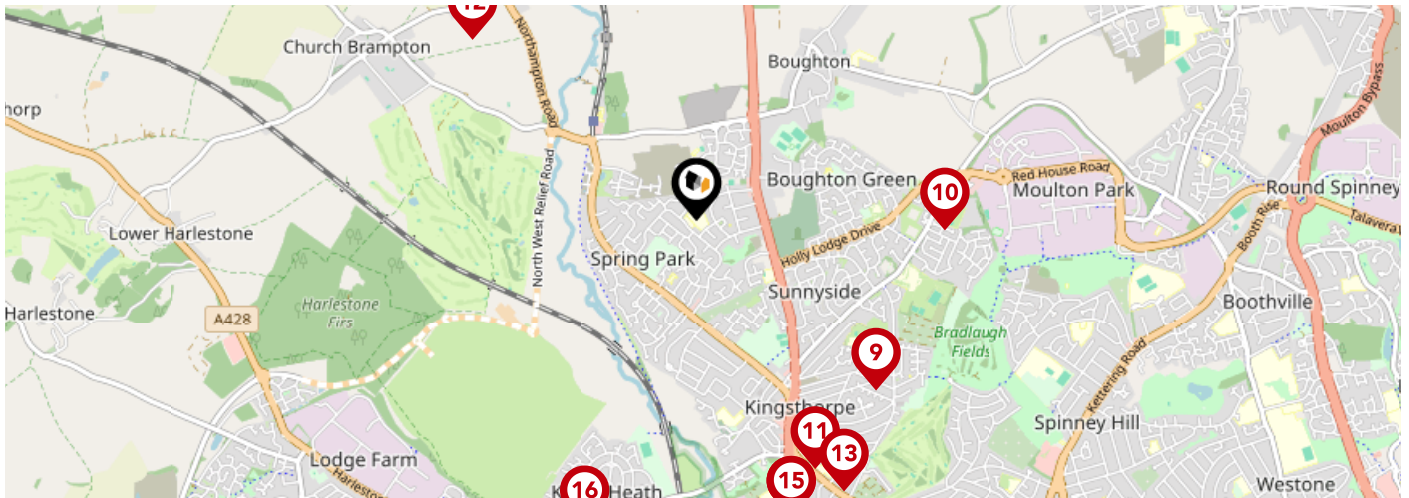

		Nursery	Primary	Secondary	College	Private
	Purple Oaks Academy Ofsted Rating: Good Pupils: 119 Distance: 1.12	<input type="checkbox"/>	<input type="checkbox"/>	<input checked="" type="checkbox"/>	<input type="checkbox"/>	<input type="checkbox"/>
	All Saints CofE VA Primary School Ofsted Rating: Good Pupils: 392 Distance: 1.13	<input type="checkbox"/>	<input checked="" type="checkbox"/>	<input type="checkbox"/>	<input type="checkbox"/>	<input type="checkbox"/>
	The Good Shepherd Catholic Primary School Ofsted Rating: Requires improvement Pupils: 291 Distance: 1.25	<input type="checkbox"/>	<input checked="" type="checkbox"/>	<input type="checkbox"/>	<input type="checkbox"/>	<input type="checkbox"/>
	The Bramptons Primary School Ofsted Rating: Good Pupils: 99 Distance: 1.3	<input type="checkbox"/>	<input checked="" type="checkbox"/>	<input type="checkbox"/>	<input type="checkbox"/>	<input type="checkbox"/>
	Kingsthorpe Grove Primary School Ofsted Rating: Good Pupils: 484 Distance: 1.4	<input type="checkbox"/>	<input checked="" type="checkbox"/>	<input type="checkbox"/>	<input type="checkbox"/>	<input type="checkbox"/>
	Northgate School Academy Trust Ofsted Rating: Outstanding Pupils: 256 Distance: 1.42	<input type="checkbox"/>	<input type="checkbox"/>	<input checked="" type="checkbox"/>	<input type="checkbox"/>	<input type="checkbox"/>
	Cambian Northampton School Ofsted Rating: Good Pupils: 25 Distance: 1.42	<input type="checkbox"/>	<input type="checkbox"/>	<input checked="" type="checkbox"/>	<input type="checkbox"/>	<input type="checkbox"/>
	Kings Heath Primary Academy Ofsted Rating: Outstanding Pupils: 347 Distance: 1.48	<input type="checkbox"/>	<input checked="" type="checkbox"/>	<input type="checkbox"/>	<input type="checkbox"/>	<input type="checkbox"/>

Area

Transport (National)

CARL MYERS



BESPOKE ESTATE AGENT

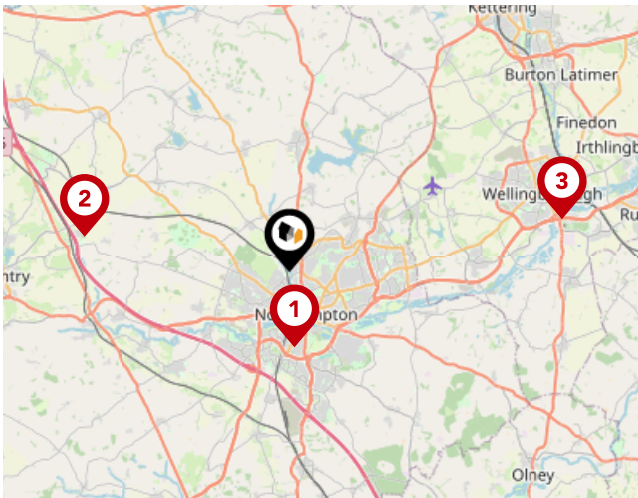

National Rail Stations

Pin	Name	Distance
	Northampton Rail Station	2.75 miles
	Long Buckby Rail Station	7.57 miles
	Wellingborough Rail Station	10.06 miles

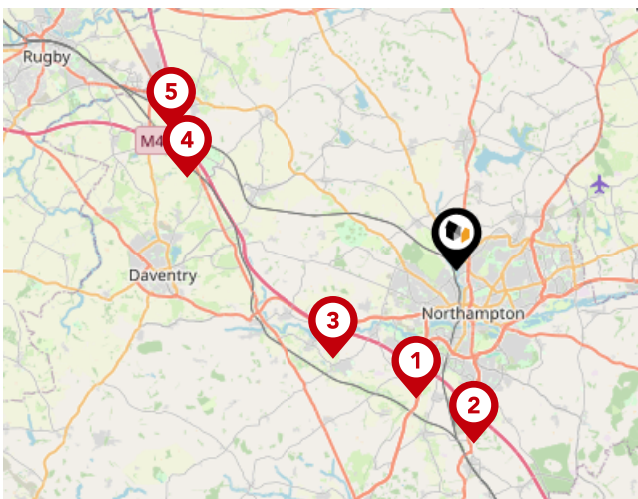

Trunk Roads/Motorways

Pin	Name	Distance
	M1 J15A	4.88 miles
	M1 J15	6.35 miles
	M1 J16	5.51 miles
	M1 J17	10.32 miles
	M1 J18	11.51 miles

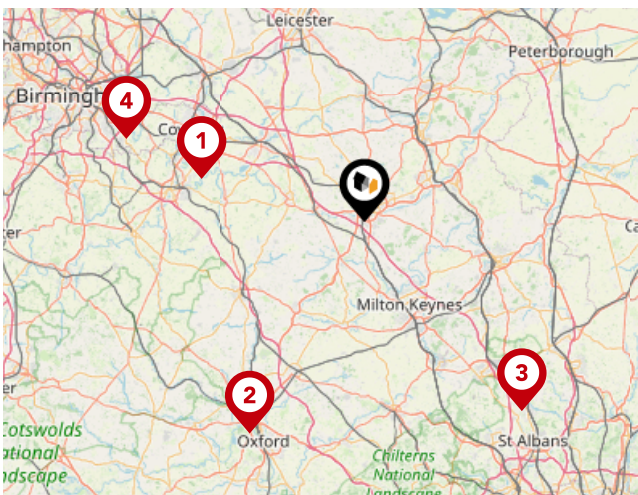

Airports/Helipads

Pin	Name	Distance
	Baginton	24.68 miles
	Kidlington	35.17 miles
	Luton Airport	35.64 miles
	Birmingham Airport	36.75 miles

Area

Transport (Local)

CARL MYERS



BESPOKE ESTATE AGENT

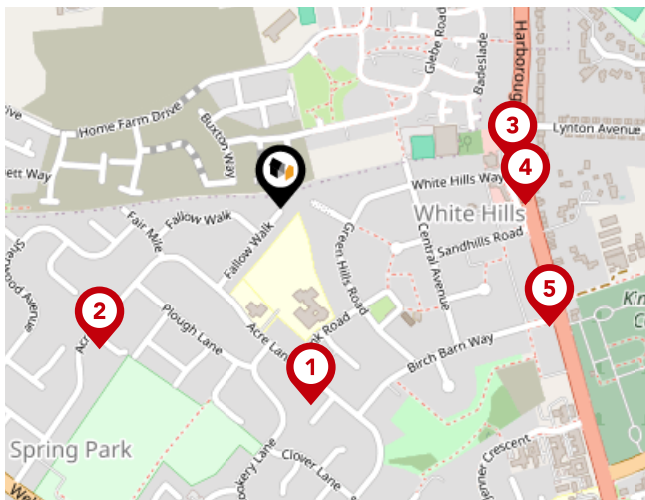

Bus Stops/Stations

Pin	Name	Distance
1	Acre Lane	0.23 miles
2	Covert Close	0.26 miles
3	The Whitehills PH	0.27 miles
4	The Whitehills PH	0.28 miles
5	Birch Barn Way	0.33 miles

Carl Myers Bespoke Estate Agent powered by eXp **About Us**

CARL MYERS



BESPOKE ESTATE AGENT

CARL MYERS



BESPOKE ESTATE AGENT

Carl Myers Bespoke Estate Agent powered by eXp

Through our Estate Agent Productivity Suite and Rightmove and Zoopla subscriptions, buyers have access to all the latest listings including those from eXp UK network of estate agents. Buyers can search on the most relevant, local criteria that means the most to them including neighbourhoods, schools, parks, house size, rooms and price, all the details that are involved in selecting the home where you'll love to live.

Carl Myers Bespoke Estate Agent powered by eXp Testimonials

CARL MYERS



BESPOKE ESTATE AGENT

Testimonial 1



1. We have sold a number of properties using Carl Myers, We have never unhappy with the service we received. Carl Myers has been excellent . He fully talked us through the whole process and his manner as been both professional yet made us feel like we was his only vendors. His communication has been second to none , always coming back extremely quickly on telephone calls and e-mails often out of working hours. I would recommend him to anyone.

Testimonial 2



On this occasion, and because of the exceptional service I have received from Carl Myers I felt a review was needed. Carl has been there every step of the way giving me exceptional service and advice that has gone beyond my expectations. Carl is very knowledgeable and passes on information in a way that is very easy to understand and made whole process run very smoothly. I would highly recommend speaking to Carl.

Testimonial 3



I have sold 2 properties with Carl Myers, he was amazing. Especially with the hassle I had with the last property I sold. he managed to keep the buyer on side through a difficult time and grateful for all his hard work. he is a credit to the industry with impeccable customer service and hopefully we will work together on other properties I am selling in the future!!



/Carl Myers Bespoke Estate Agent



/carl_myers_bespoke

Carl Myers Bespoke Estate

Agent powered by eXp

Data Quality

We are committed to comprehensive property data being made available upfront to make the home buying and selling process quicker, easier and cheaper. This is why we have partnered with Sprift, the UK's leading supplier of property-specific data.



Contains public sector information licensed under the Open Government License v3.0

The information contained within this report is for general information purposes only and to act as a guide to the best way to market your property for the asking price.

Sprift Technologies Ltd aggregate this data from a wide variety of sources and while we endeavour to keep the information up to date and correct, we make no representations or warranties of any kind, express or implied, about the completeness, accuracy, reliability, of the information or related graphics contained within this report for any purpose.

Any reliance you place on such information is therefore strictly at your own risk. In no event will we be liable for any loss or damage including without limitation, indirect or consequential loss or damage, or any loss or damage whatsoever arising from loss of data or profits arising out of, or in connection with, the use of this report.



Carl Myers Bespoke Estate Agent powered by eXp

Kettering

07867 528633/01536 903036

carl.myers@exp.uk.com

www.carlmyers.co.uk

