



Your Logo

27 Boot Close,  
£500,000

3 2 1



- Detached new build house on exclusive development
- Three bedrooms, two bathrooms with one ensuite
- Spacious family kitchen diner
- Downstairs cloakroom
- Views to open fields from the garden
- Finished to the highest specification
- 10 Year Premier Warranty
- Walking distance to Winslow Market Square
- Stamp Duty Paid
- Quote AS0701 on Rightmove





Approximate Gross Internal Area  
 Ground Floor = 55.6 sq m / 598 sq ft  
 First Floor = 54.3 sq m / 584 sq ft  
 Total = 109.9 sq m / 1182 sq ft

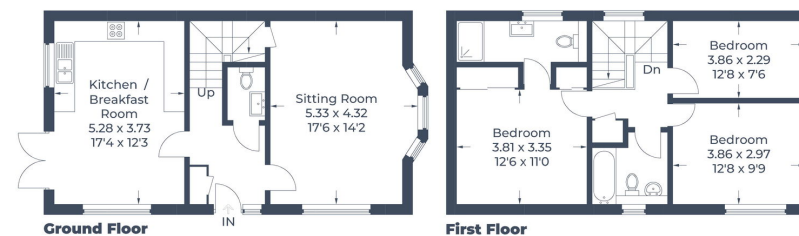

Illustration for identification purposes only,  
 measurements are approximate, not to scale.  
 © C3 Property Marketing Produced for EXP

Stunning detached three bedroom house with off street parking for two cars on the superb by WE Black development within walking distance to Winslow Market Square.

79

86