



JON-PAUL BRAMPTON POWERED BY **exp** TM UK

@jon-paul.brampton@exp.uk.com

🌐 jonpaulbrampton.exp.uk.com

☎ 07359 015 020



# Nup End Lane, Wingrave, Buckinghamshire

Offers Over £385,000

🛏️ 2 🚿 1 🚗 2





- Rothschild's built cottage
- Garden room - with services
- Courtyard garden
- Spa-like upstairs bathroom
- Watch the video tour
- Two bedrooms
- Stunning kitchen
- Immaculately presented throughout
- Charming collage location
- Please quote JB0294 when enquiring through Rightmove, Zoopla or OnTheMarket,



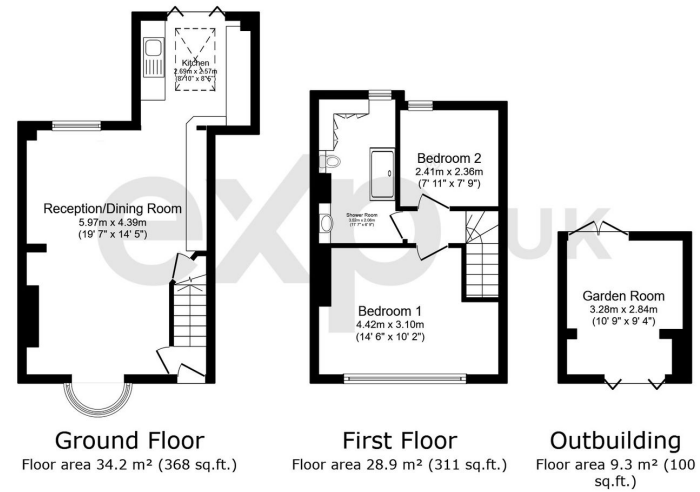

**TOTAL: 72.4 m<sup>2</sup> (779 sq.ft.)**

This floor plan is for illustrative purposes only. It is not drawn to scale. Any measurements, floor areas (including any total floor area), openings and orientations are approximate. No details are guaranteed, they cannot be relied upon for any purpose and do not form any part of any agreement. No liability is taken for any error, omission or misstatement. A party must rely upon its own inspection(s). Powered by www.Propertybox.io

Jon-Paul Brampton presents...two bedroom Rothschild's cottage (with outbuilding) in the charming Buckinghamshire village of Wingrave.

88

70