

MARTIN DREW

POWERED BY
exp UK

83 Church Street, Helmdon

£599,995

🛏️ 4 🚿 2 🚗 2



Set in the ever popular village of Helmdon, this well presented & spacious 4 bedroom detached family home, with purpose built garden room (& shower room) further boasts Oversized garage, Large rear garden & Field views. Simply a must view to appreciate size & location.

M: 07970663757

E: martin.drew@exp.uk.com

W: www.martin.drew.exp.uk.com



Key Features

- 4 bedrooms
- Kitchen/Dining/Family room
- Oversized garage with parking
- 4 piece family bathroom
- Entrance porch/hallway
- Garden room with ensuite shower
- Living room
- Large rear garden
- Downstairs WC
-

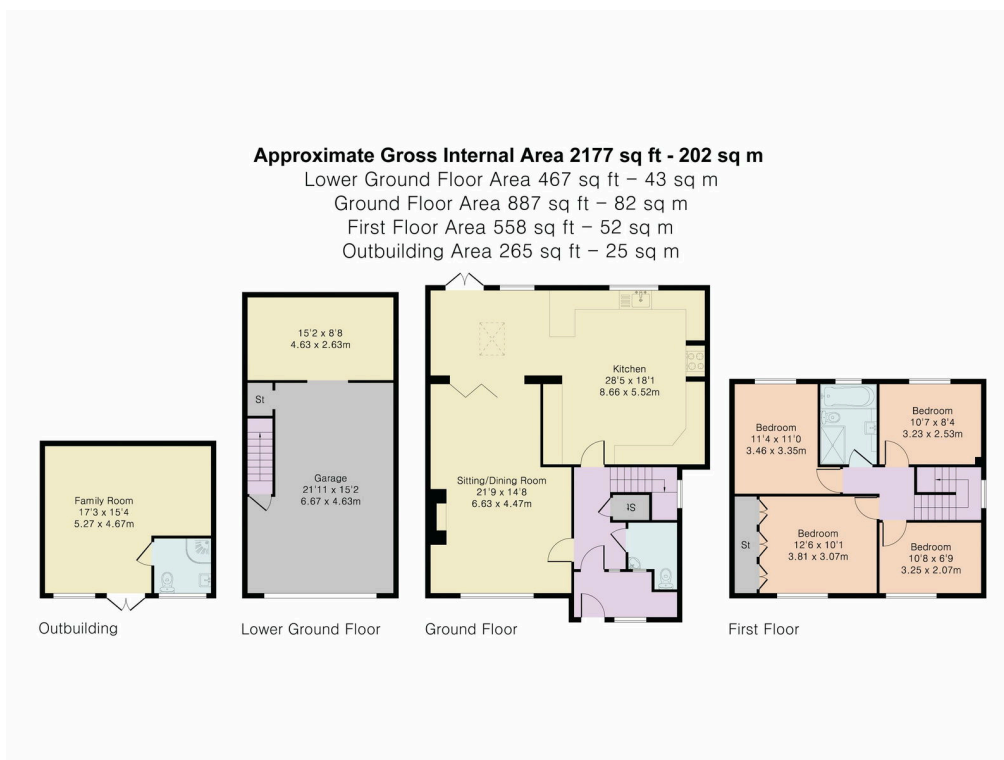

Although Pink Plan Ltd ensures the highest level of accuracy, measurements of doors, windows and rooms are approximate and no responsibility is taken for error, omission or misstatement. These plans are for representation purposes only as defined by RICS code of measuring practice. No guarantee is given on total square footage of the property within this plan. The figure icon is for initial guidance only and should not be relied on as a basis of valuation.

