



ANITA SANFORD

exp[®] UK

@anita.sanford@exp.uk.com

anitanford.exp.uk.com

07702 259 092

The Willows, Nash Road, Thornborough

Guide Price £1,375,000

🛏️ 4 🚿 3 🚗 4



- 18th Century detached house • Separate two storey annexe
- Four bedrooms, bathroom , shower room • Four reception rooms
- Downstairs cloakroom, utility • Detached double garage and boot room
- Carriage driveway • Generous plot of 0.55 acres
- Outdoor swimming pool • Village location, Royal Latin school catchment



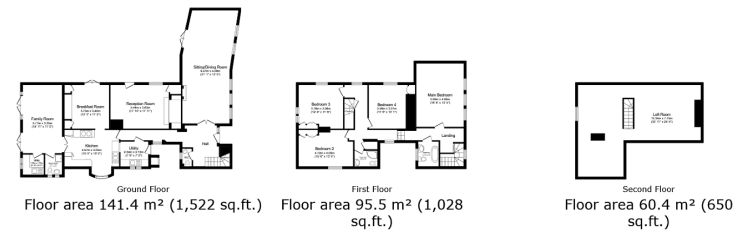

TOTAL: 356.2 m² (3,834 sq.ft.)

This floor plan is for illustrative purposes only. It is not drawn to scale. Any measurements, floor areas (including any total floor area), openings and orientations are approximate. No details are guaranteed, they cannot be relied upon for any purpose and do not form any part of any agreement. No liability is taken for any error, omission or misstatement. A party must rely upon its own inspection(s). Powered by www.PropertyBox.io

A fabulous detached house on a generous plot with a separate annexe in the sought after village of Thornborough

Energy performance certificate (EPC)									
The Willows North Road Thornborough DN22 9JG 66/18/2011	<table border="1"> <tr> <td>Energy rating</td> <td>E</td> <td>Valid until</td> <td>18 June 2021</td> </tr> <tr> <td>Certificate number</td> <td>4902-2428-6660-7726-2206</td> <td></td> <td></td> </tr> </table>	Energy rating	E	Valid until	18 June 2021	Certificate number	4902-2428-6660-7726-2206		
Energy rating	E	Valid until	18 June 2021						
Certificate number	4902-2428-6660-7726-2206								
Property type	Detached house								
Total floor area	256 square metres								
Rules on letting this property									
Properties can be let if they have an energy rating from A to E.									
You can read guidance for landlords on the regulations and exemptions https://www.gov.uk/guidance/domestic-private-rented-property-minimum-energy-efficiency-standard-landlord-guidance									