



## 49 Coopers Green

£550,000

 4  3  3



- private rear garden
- family bathroom
- cloakroom
- dining room
- kitchen/dining/family room
- garage with parking
- utility room
- master with ensuite
- living room
- 4 bedrooms

M: 07970663757

E: martin.drew@exp.uk.com

W: www.martin.drew.exp.uk.com



# MARTIN DREW

POWERED BY  
**exp** UK



Approximate Gross Internal Area 1610 sq ft – 150 sq m  
Ground Floor Area 948 sq ft – 88 sq m  
First Floor Area 662 sq ft – 62 sq m

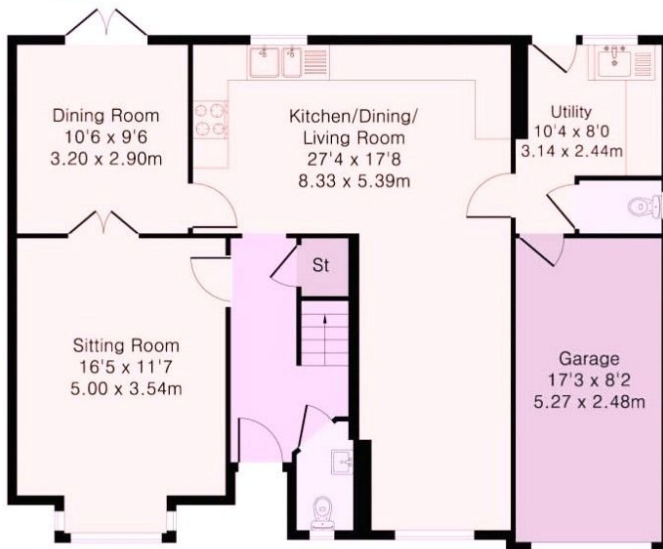

Ground Floor

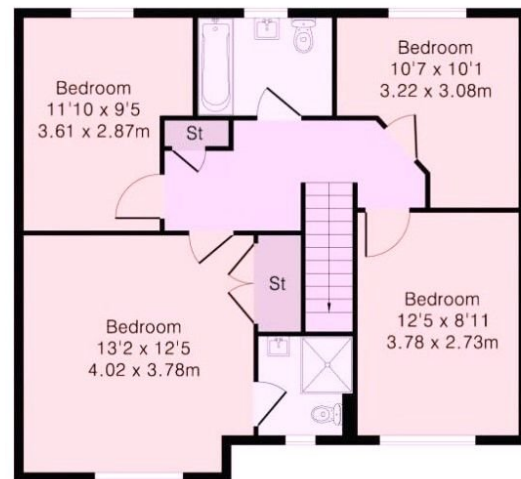

First Floor

A well presented & spacious 4 bedroom detached family home with 3 reception rooms & private garden. Ref: MD0803-838305

M: 07970663757

E: martin.drew@exp.uk.com

W: www.martin.drew.exp.uk.com

