



KATY POORE

exp[®] UK

@katy.poore@exp.uk.com

🌐 katypoore.exp.uk.com

📞 07930 019 620

Langley Close, PE27 5SE

Guide Price £200,000

🛏️ 2 🚿 1 🚗 1



- Close to Town Centre
- Versatile Accommodation
- Enclosed Rear Garden
- No Forward Chain
- Tenant Would Stay If Buy To Let
- South of St Audrey's Lane
- Two Double Bedrooms
- Currently Achieving £1,000 in rent
- Low Service Charge & Ground Rent
- Energy Rating: C & Council Tax Band A





Ground Floor
Approx. 17.5 sq. metres (188.0 sq. feet)

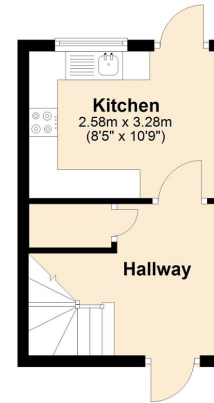

First Floor
Approx. 44.3 sq. metres (476.4 sq. feet)

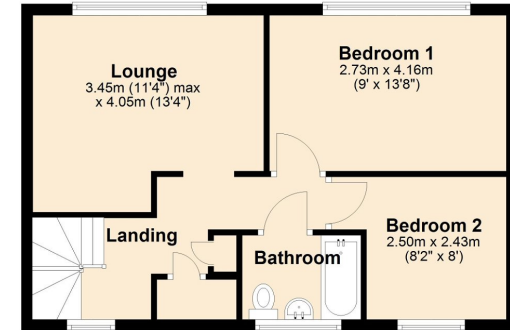

Total area: approx. 61.7 sq. metres (664.4 sq. feet)

Attention first time/investment buyers, fantastic opportunity to acquire this 2 bed maisonette. Within walking distance to the guided busway and St. Ives town centre offered with no forward chain!

