



LEE WILKINSON

POWERED BY
exp UK

5 Elizabeth Drive, Chedburgh

Offers Over £375,000

3 1 1

- Superb village location
- Quiet cul-de-sac
- Open plan kitchen/diner
- Gardens to front, rear and side
- Wood burner
- Close to Bury St Edmunds
- Three good size bedrooms
- Detached garage
- Driveway with parking for four vehicles
- Property Ref LW0712



Lee Wilkinson Estate Agents are pleased to present this lovely three bedroom bungalow in the sought after village of Chedburgh. The property is located approximately six miles from the Suffolk market town of Bury St Edmunds, which offers a great range of both leisure and retail facilities, as well as West Suffolk Hospital, and a range of excellent schools and college. Elizabeth Drive is a quiet cul-de-sac, benefitting from a mix of both houses and bungalows, and this particular property has fantastic views over fields to the front aspect. The property itself is of a good standard, with recent refurbishment having been undertaken. There is also a good sized garden which can be utilised in a number of ways, depending on the new owners and a detached garage, and plenty of parking to the side of the property.

Ref LW0712





GROUND FLOOR
961 sq.ft. (89.3 sq.m.) approx.

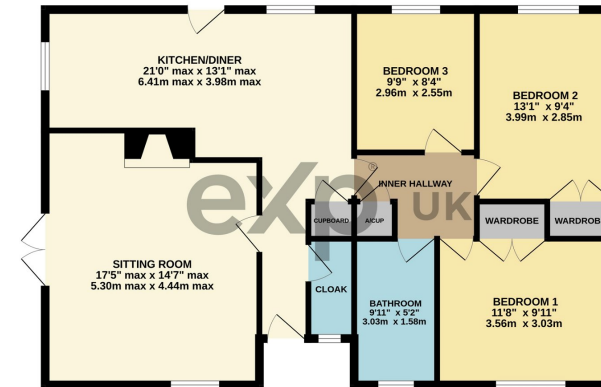

TOTAL FLOOR AREA: 961 sq.ft. (89.3 sq.m.) approx.
While every attempt has been made to ensure the accuracy of the floorplan, the measurements of doors, windows, stairs and any other items are approximate and no responsibility is taken for any errors, omissions or misstatements. The floorplan is for illustrative purposes only and should be used as a guide only by the prospective purchaser. The services, systems and materials shown have been listed and are guaranteed. More info: www.exp.co.uk

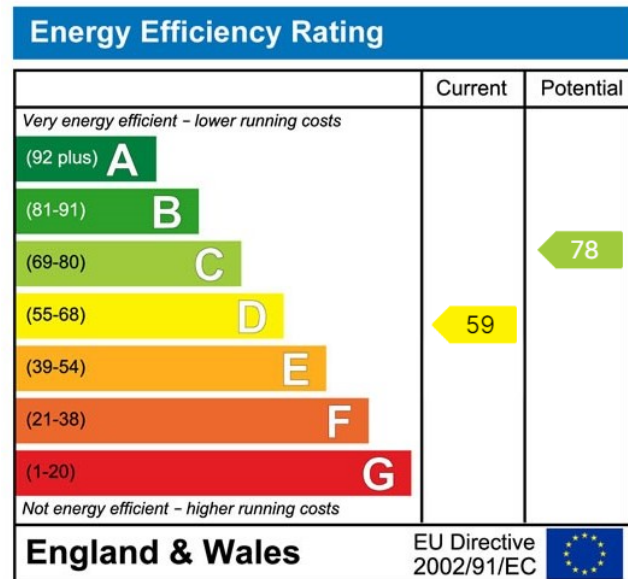

LEE WILKINSON

POWERED BY
exp UK