



LEE WILKINSON

POWERED BY
exp UK

14 Browns Close, Wickhambrook

£450,000

🛏️ 4 🚿 2 🛋️ 2

- Quiet location
- Well maintained
- Large kitchen/breakfast room
- Detached garage
- Ref LW0712
- Close to village amenities
- Flexible accommodation
- Front and rear gardens
- Four double bedrooms



A well presented 4 bedroom detached bungalow, set in the superb village of Wickhambrook, close to local amenities and towards the end of a quiet cul-de-sac. Browns Close has the benefit of being situated on a no through road, but yet still has great access to the village shop and Post Office, as well as the public house, primary school and doctors surgery, all within easy walking distance. Wickhambrook, benefits from good road links to Newmarket, Haverhill and Bury St Edmunds, as well as Sudbury and Cambridge slightly further afield.

Ref LW0712



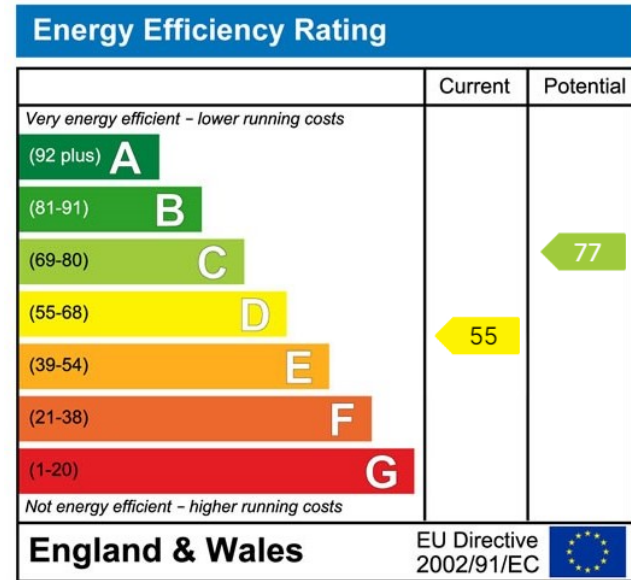
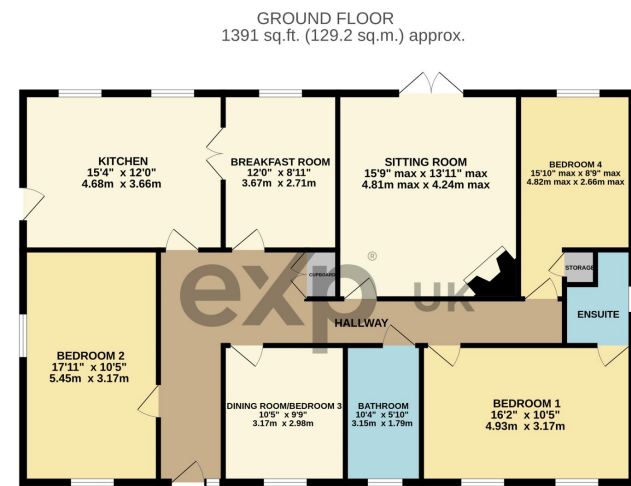

LEE WILKINSON

POWERED BY
exp UK