

65 High Street, Yelvertoft

Guide Price £195,000

2 1 1

**Welcome to Boaters Cottage, High Street Yelvertoft.**

A pretty end of terrace 2 bedroom cottage in the popular village of Yelvertoft

Charming Two-Bedroom Victorian Home in the Heart of Yelvertoft

We're delighted to bring to market this characterful two-bedroom Victorian end-of-terrace home, perfectly positioned in the sought-after village of Yelvertoft. As a local agent, we know how rarely homes like this come available—steeped in charm, full of personality, and just a stone's throw from village amenities and scenic countryside.

LOUISE OWEN



@louise.owen@exp.uk.com

 louiseowen.exp.uk.com

 07774 122 959

Key Features

- Two Bedrooms
- Popular Village Location
- Off street parking
- Double Glazing
- Country style gardens
- Storage shed
- New solar Panels heating system
- Village pub and shop
- Local schools
- Property Ref LO 0765

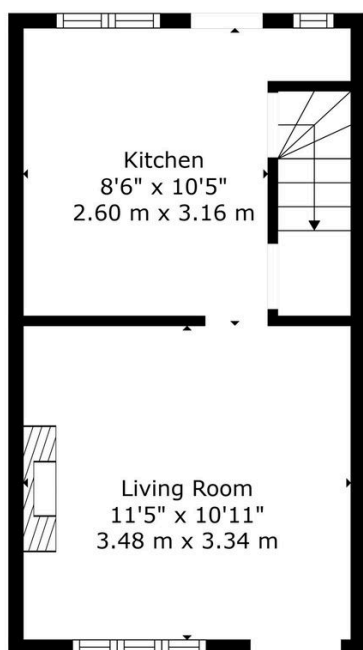

Floor 1

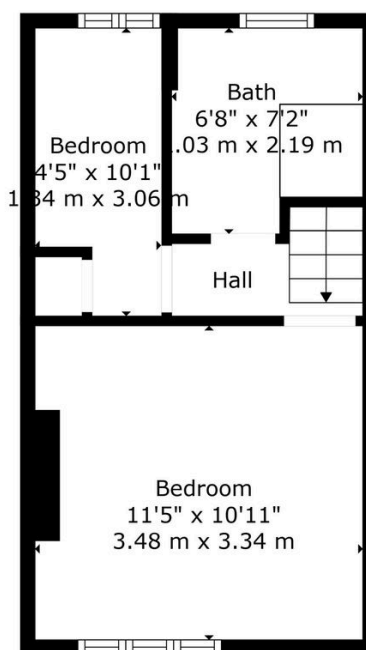

Floor 2

TOTAL: 488 sq. ft, 46 m²
FLOOR 1: 244 sq. ft, 23 m², FLOOR 2: 244 sq. ft, 23 m²
Floor Plan Created By Harper & Reid. Measurements Deemed Highly Reliable But Not Guaranteed

