

Your Logo

## Brooklyn House, 52, Lambley Lane, Burton Joyce

Guide Price £500,000

🛏 3 🚿 3 🛋 2



# Your Logo

- REF-CG0973
- Dining Kitchen with Utility Room
- Master Bedroom with Ensuite and Dressing Room
- Stunning Private Garden
- Large Single Garage
- Detached Cottage
- Two Reception Rooms
- Three bathrooms
- Off Road Driveway Parking
- Peaceful Village Location

Approximate Gross Internal Area  
2093 Sq.ft. (194.49 sq.m.)

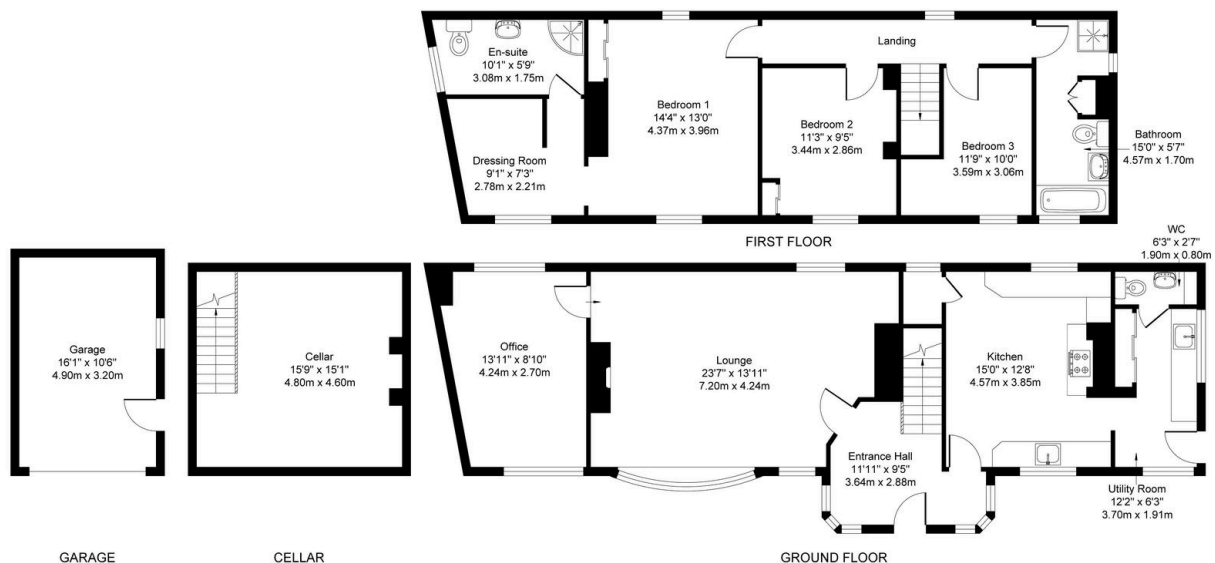

**GUIDE PRICE £500,000 - £525,000**

**REF-CG0973**

Nestled in the heart of the picturesque village of Burton Joyce, this charming 200-250-year-old period cottage offers an enviable lifestyle of tranquility and convenience. Set within a generous plot, this home beautifully blends timeless character with modern comforts, making it a true

*Your Logo*

sanctuary for those seeking a balance between rural beauty and family living. This home is more than just a residence—it's a lifestyle. Whether enjoying cozy evenings by the fireplace, hosting family gatherings in the spacious kitchen, or embracing the outdoor beauty, this property offers an exceptional opportunity to experience village living at its finest. Viewing is essential to fully appreciate all that this stunning home has to offer.