

Your Logo

## 24 Failsworth Close

Guide Price £220,000

3 1 2



# Your Logo

- CG0973
- Modern Interior
- Semi Detached Family Home
- Off Road Parking
- Great Commuter Location
- 3 Bedrooms
- Kitchen Diner
- Conservatory
- Private Rear Garden
- Large Corner Plot

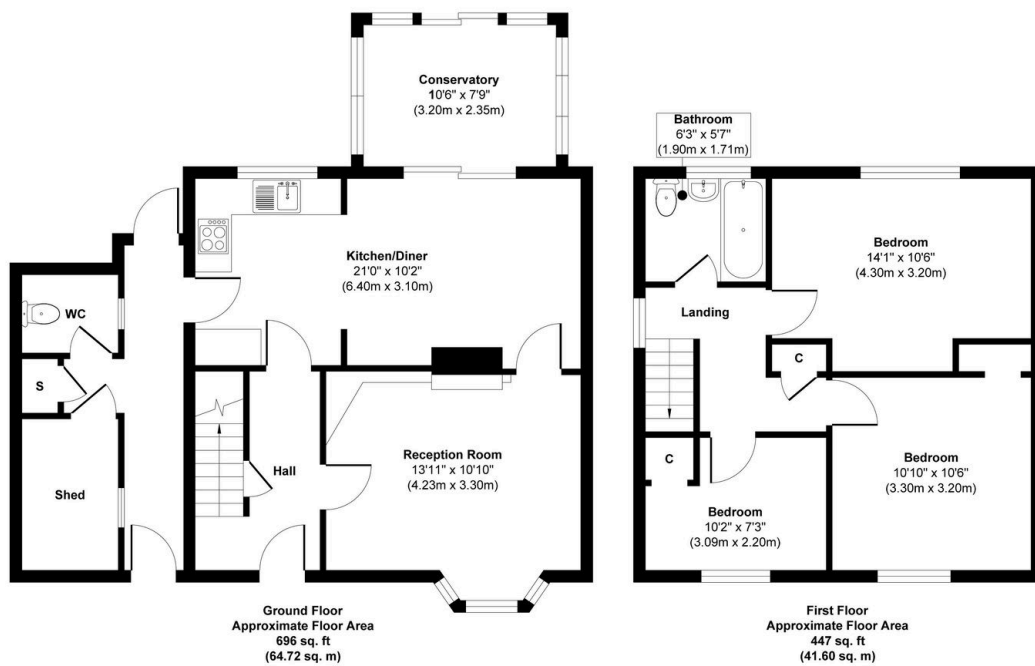

**Approx. Gross Internal Floor Area 1143 sq. ft / 106.32 sq. m**  
Illustration for identification purposes only, measurements are approximate, not to scale.

**Guide Price £220,000 - £240,000**

**REF: CG0973**

Welcome to this spacious three-bedroom semi-detached family home, nestled on an expansive corner plot in Clifton, Nottingham. This delightful property combines both comfort and modern living with practicality and convenience, making it an ideal choice for families, couples, or anyone

*Your Logo*

seeking a versatile and well-located home. With a large plot offering extra land to the side, a private walled garden, and easy access to both regional and national transportation networks, this home presents a rare opportunity in today's market.