

# FOR SALE

07880 342188  
paul.cutmore@exp.uk.com  
paulcutmore.exp.uk.com



Taunton Road, Bourne, PE10 0XE

£219,995

3 2 2



A beautifully presented and maintained Three bedroom mid terraced home, situated on the popular Elsea Park development. Boasting an ensuite shower room, cloakroom and off road parking for two cars, this property is a must view for your first family home.

PAUL CUTMORE





## Key Features

- Three Bedrooms
- Beautifully presented
- Popular Location
- 
- 
- Ensuite
- Off Road Parking
- Quote ref PC0713
- 
- 

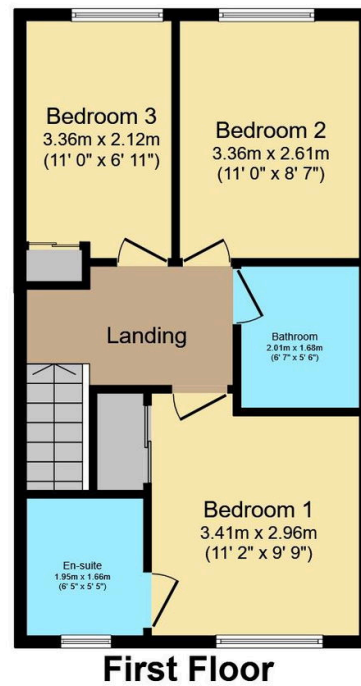
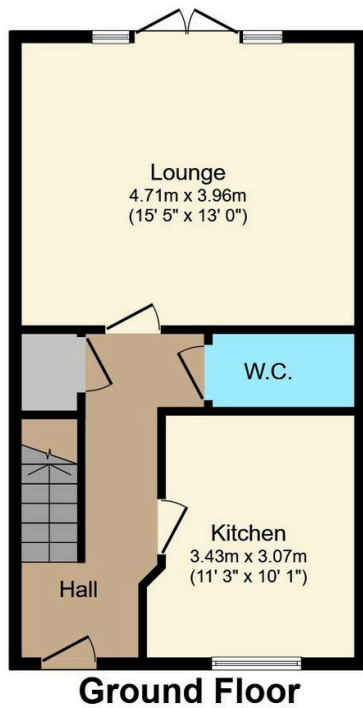

Total floor area 81.8 m<sup>2</sup> (880 sq.ft.) approx

This floor plan is for illustrative purposes only. It is not drawn to scale. Any measurements, floor areas (including any total floor area), openings and orientation are approximate. No details are guaranteed, they cannot be relied upon for any purpose and they do not form part of any agreement. No liability is taken for any error, omission or misstatement. A party must rely upon its own inspection(s). Powered by [www.focalagent.com](http://www.focalagent.com)